

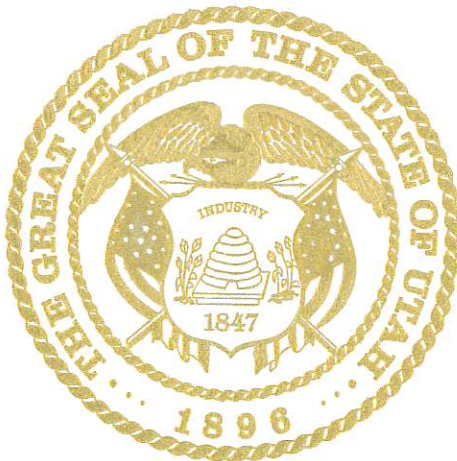

OFFICE OF THE LIEUTENANT GOVERNOR
CERTIFICATE OF BOUNDARY ADJUSTMENT

I, SPENCER J. COX, LIEUTENANT GOVERNOR OF THE STATE OF UTAH,
HEREBY CERTIFY THAT there has been filed in my office a notice of boundary
adjustment between the CITY OF ST. GEORGE and the CITY OF SANTA CLARA,
dated April 17, 2020 and May 26, 2020, complying with Section §10-2-425, Utah Code
Annotated, 1953, as amended.

NOW, THEREFORE, notice is hereby given to all whom it may concern that the
attached is a true and correct copy of the notice of boundary adjustment, referred to
above, on file with the Office of the Lieutenant Governor pertaining to the CITY OF ST.
GEORGE and the CITY OF SANTA CLARA, located in Washington County, State of
Utah.



IN TESTIMONY WHEREOF, I have
hereunto set my hand, and affixed the Great
Seal of the State of Utah this 26th day of
May 2020 at Salt Lake City, Utah.

A handwritten signature in black ink, appearing to read "Spencer J. Cox".

SPENCER J. COX
Lieutenant Governor

Notice of Impending Boundary Action

Dear Lieutenant Governor:

Pursuant to §10-2-425 Utah Code Annotated, the City of Santa Clara as the Local Entity hereby gives notice to the Lieutenant Governor of its intent to adjust the boundary line between the Santa Clara City and City of St. George.

Santa Clara is transferring 1.6 acres from Santa Clara City to City of ST. George.

I, Rick Rosenberg, Mayor of Santa Clara City, hereby certify that Santa Clara City complied with all the requirements applicable to the boundary line adjustment. Santa Clara City request that the Lieutenant Governor issue a certificate of boundary line adjustment pursuant to §10-2-425 Utah Code Annotated.

Dated this 26 day of May 2020.
Santa Clara City

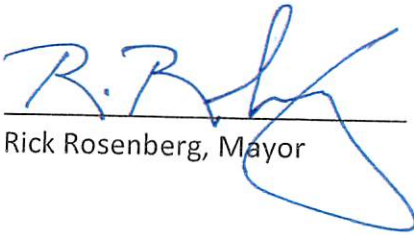
Rick Rosenberg, Mayor

Attest:

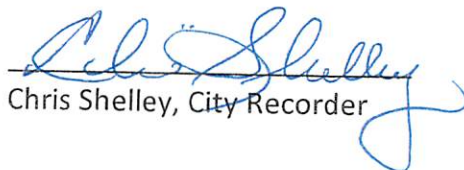
Chris Shelley, City Recorder



NOTICE OF IMPENDING BOUNDARY ACTION

Dear Lieutenant Governor:

Pursuant to §10-2-425 Utah Code Annotated, the City of St. George as the Local Entity hereby gives notice to the Lieutenant Governor of its intent to adjust the boundary line between the City of St. George and Santa Clara City on the South side of Sunset Boulevard at Tuweap Drive.

I, Jonathan T. Pike, Mayor of the City of St. George, hereby certify that the City of St. George complied with all the requirements applicable to the annexation of this property.

Dated this 17th day of April, 2020.

CITY OF ST. GEORGE



Jonathan T. Pike
Mayor

ATTEST:

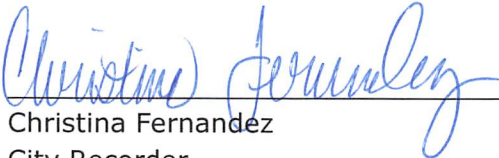

Christina Fernandez
City Recorder



Enclosures: Approved Final Local Entity Plat
 Annexation Ordinance

SB-6-2-22-1413
SC-6-2-15-233

DOC # 20200021972

Ordinance Page 1 of 3
Russell Shirts Washington County Recorder
05/04/2020 03:48:23 PM Fee \$ 0.00
By SANTA CLARA CITY

**CITY OF SANTA CLARA
ORDINANCE 2020-04**

**AN ORDINANCE ADJUSTING THE MUNICIPAL BOUNDARY LINE BETWEEN THE
CITY OF ST. GEORGE AND SANTA CLARA CITY.**

WHEREAS, the City of Santa Clara has received a request from the City St. George and Dean Terry, property owner, to adjust the common boundary with the City of St. George transferring approximately 1.6 acres from City of Santa Clara along the canal on the south side of Sunset Blvd. across from the intersection with Tuweap Drive. described in Exhibit A; and

WHEREAS, the property owner has requested this consideration, due to his donation of the flood plain property to the City of St. George and the canal has recently been relocated slightly to the west & makes since to add this property to City of St. George since the canal has been the boundary line between the two cities; and

WHEREAS, Utah Code Annotated § 10-2-419 allows for municipalities having a common boundary to adjust the boundary by adopting a resolution indicating the intent to adjust the boundary, and to give subsequent notice of the intent, and hold a public hearing as required by law; and

WHEREAS, the City Council adopted such a resolution on Jan. 8, 2020, and held a public hearing on this request on March 11, 2020; and

NOW, THEREFORE, BE IT ORDAINED by the City Council of the City of Santa Clara, the City Municipal Boundary is adjusted, pursuant to Utah Code Annotated § 10-2-419 as described on the attached property legal description, Exhibit "A." This Ordinance is effective on the date executed below.

APPROVED AND ADOPTED this 11th day of March 2019.

Attest:



CHRIS SHELLEY, City Recorder

IN WITNESS THERETO:

RICK ROSENBERG, Mayor



City Line Adjustment Description

Beginning at a point South 89°20'18" East 471.25 feet along the section line from the North Quarter Corner of Section 22, Township 42 South, Range 16 West, Salt Lake Base & Meridian, and running;

thence North 20°43'57" East 98.49 feet to the southerly line of the Dixie Downs Addition;
thence South 69°16'03" East 155.20 feet along said southerly line of said Dixie Downs Addition and to and along the northerly line of the Santa Clara Addition No. 5;

thence southerly the following (4) courses along the easterly line of said Santa Clara Addition No. 5;

thence South 20°43'57" West 209.89 feet;

thence South 48°08'33" East 124.72 feet;

thence South 35°56'17" East 211.93 feet;

thence South 32°36'03" East 180.17 feet;

thence North 48°09'53" West 70.01 feet;

thence North 48°09'53" West 72.15 feet;

thence North 51°19'38" West 228.58 feet;

thence Northwest 95.19 feet along an arc of a 546.44 foot radius curve to the right (center bears North 38°40'22" East, long chord bears North 46°20'13" West 95.07 feet with a central angle of 09°58'51");

thence Northwest 93.96 feet along an arc of a 546.44 foot radius curve to the right (center bears North 48°39'13" East, long chord bears North 36°25'13" West 93.85 feet with a central angle of 09°51'08");

thence North 130.09 feet along an arc of a 213.86 foot radius curve to the right (center bears North 58°30'21" East, long chord bears North 14°04'07" West 128.09 feet with a central angle of 34°51'04");

thence North 03°21'25" East 62.97 feet;

thence South 89°20'13" East 16.26 feet to the Point of Beginning.

Containing 72,394 square feet or 1.66 acres.



March 4, 2020

CONFIDENTIAL

... of
... ..

... ..
... ..
... ..

... ..
... ..
... ..
... ..

... ..
... ..
... ..
... ..

... ..

... ..

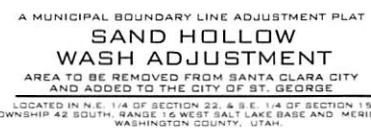

A MUNICIPAL BOUNDARY LINE ADJUSTMENT PLAT

**SAND HOLLOW
WASH ADJUSTMENT**

AREA TO BE REMOVED FROM SANTA CLARA CITY
AND ADDED TO THE CITY OF ST. GEORGE

LOCATED IN N.E. 1/4 OF SECTION 22, & S.E. 1/4 OF SECTION 15
TOWNSHIP 42 SOUTH, RANGE 15 WEST, S4E, NE BRIDGE AND MERIDIAN
WASHINGTON COUNTY, UTAH

THE UNIVERSITY OF CHICAGO PRESS
54 EAST LAKE STREET, CHICAGO, ILL. 60601
U.S.A. AND CANADA

INTERNET: 1-800-843-8841
FAX: 312-908-8841

RESOLUTION NO. 2020-01R

A RESOLUTION STATING INTENT OF CITY OF SANTA CLARA TO ADJUST A COMMON BOUNDARY WITH CITY OF ST. GEORGE FOR 1.6 ACRES OWNED BY CITY OF SANTA CLARA, AND REQUEST FOR DISCONNECTION

WHEREAS, the purpose of this Resolution of Intent is to adjust the common boundary with the City St. George by transferring 1.6 acres to the City of St. George in the area along the canal on the south side of Sunset Blvd. across from the intersection with Tuweap Drive.

WHEREAS, Mr. Terry, property owner has donated this flood plain property to the City of St. George and the canal has been relocated slightly to the west, it makes sense to add this property to the City of St. George since the canal has been the boundary line between the two cities, and

WHEREAS, the property is not developable due to being adjacent to the canal and within the flood plain, and

WHEREAS, the City of Santa Clara believes that the current location and status of the property is such that it will meet all tests for disconnection, as required by Utah Code Ann. §10-2-501 et. seq; and

WHEREAS, the City Council has determined that it is in the best interests of the City of Santa Clara to disconnect from Santa Clara and that the City of St. George and City Santa Clara mutually agree to adjust their boundaries to move said 1.6 acres from the City of Santa Clara' municipal boundaries, to the municipal boundaries of St. George City, and

NOW, THEREFORE, it is hereby resolved by the City Council of the City of Santa Clara, as follows:

1. The City of Santa Clara hereby requests that Santa Clara City disconnect certain property described in Exhibit A hereto, a 1.6-acre parcel, on the following grounds:

- a. That the said property is owned by the Santa Clara in fee;
- c. The City of Santa Clara requests of the City Council of the City of St. George participate in a boundary adjustment, under Utah Code Ann. §10-2-419.
- d. That the property, which is an undeveloped raw parcel, is not currently receiving utility service from the Santa Clara City, is not bonded in any material way, and all requirements for disconnection under Utah Code Ann. §10-2-601 et seq. regarding disconnection are evidence.

2. The staff of the City of Santa Clara is directed to present this Resolution to the City of St. George for the mutual boundary adjustment, and further directing the staff to proceed with all necessary requirements to have said property disconnected from Santa Clara City and added to City St. George, as may be required by Utah Code Ann. §10-2-419, and/or Utah Code Ann. §10-2-501, et seq.

DATED this 8 day of Jan. 2020.

(SEAL)



IN WITNESS THERETO:



RICK ROSENBERG, Mayor

ATTEST:



CHRIS SHELLEY, Recorder

ORDINANCE NO. 2020-04-003

**AN ORDINANCE ADJUSTING A COMMON MUNICIPAL BOUNDARY LINE WITH
THE CITY OF SANTA CLARA, UTAH**
(Applicant Dean Terry)

WHEREAS, the City of St. George has received a request from Dean Terry, property owner, to consider a boundary line adjustment with the City of Santa Clara for property located on both sides of the common municipal boundary fully described in Exhibit A, attached hereto and incorporated herein. It is proposed that property would be moved from the City of Santa Clara, and the same property would be added to the City of St. George;

WHEREAS, the property owner has requested this consideration in order to better align the property owner's land boundary with the municipal property boundaries, because the property is bifurcated between the City of St. George and the City of Santa Clara;

WHEREAS, Utah Code Annotated Section 10-2-419 allows for municipalities having a common boundary to adjust the boundary by adopting a resolution declaring its intent to adjust the common boundary line between St. George and Santa Clara, after giving notice and holding a public hearing as required by law; and

WHEREAS, the Council adopted such a resolution on January 9, 2020, and held a public hearing on this request on April 16, 2020.

NOW, THEREFORE, BE IT ORDAINED, by the St. George City Council, that the municipal boundary between the City of St. George and the City of Santa Clara is adjusted, pursuant to Utah Code Annotated Section 10-2-419, as described on the attached property legal description, Exhibit A. This Ordinance is effective on the date executed below and in accordance with law.

APPROVED AND ADOPTED this 16th day of April, 2020.

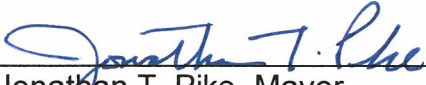
Jonathan T. Pike, Mayor

ATTEST:

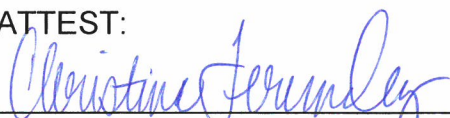
Christina Fernandez, City Recorder

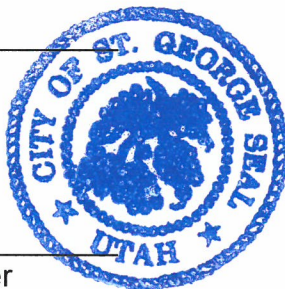

City Line Adjustment Description

Beginning at a point South 89°20'18" East 471.25 feet along the section line from the North Quarter Corner of Section 22, Township 42 South, Range 16 West, Salt Lake Base & Meridian, and running;

thence North 20°43'57" East 98.49 feet to the southerly line of the Dixie Downs Addition;
thence South 69°16'03" East 155.20 feet along said southerly line of said Dixie Downs Addition and to and along the northerly line of the Santa Clara Addition No. 5;
thence southerly the following (4) courses along the easterly line of said Santa Clara Addition No. 5;
thence South 20°43'57" West 209.89 feet;
thence South 48°08'33" East 124.72 feet;
thence South 35°56'17" East 211.93 feet;
thence South 32°36'03" East 180.17 feet;
thence North 48°09'53" West 70.01 feet;
thence North 48°09'53" West 72.15 feet;
thence North 51°19'38" West 228.58 feet;
thence Northwest 95.19 feet along an arc of a 546.44 foot radius curve to the right (center bears North 38°40'22" East, long chord bears North 46°20'13" West 95.07 feet with a central angle of 09°58'51");
thence Northwest 93.96 feet along an arc of a 546.44 foot radius curve to the right (center bears North 48°39'13" East, long chord bears North 36°25'13" West 93.85 feet with a central angle of 09°51'08");
thence North 130.09 feet along an arc of a 213.86 foot radius curve to the right (center bears North 58°30'21" East, long chord bears North 14°04'07" West 128.09 feet with a central angle of 34°51'04");
thence North 03°21'25" East 62.97 feet;
thence South 89°20'13" East 16.26 feet to the Point of Beginning.

Containing 72,394 square feet or 1.66 acres.



March 4, 2020

CERTIFICATION OF CITY OF ST. GEORGE
ORDINANCE NO. 2020-04-003

Pursuant to Utah Code §10-3-713, I hereby certify that on the 16th day of April, 2020, the St. George City Council passed Ordinance No. 2020-04-003 and that said ordinance was posted at the St. George City Offices, 175 E. 200 N., the St. George City Commons Building, 220 N. 200 E., and the Washington County Administrative Offices, 197 E. Tabernacle on April 20, 2020.

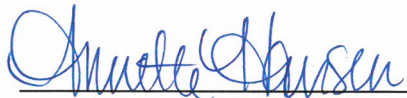
Christina Fernandez - *Annette Hansen*
St. George City Recorder, *Deputy*



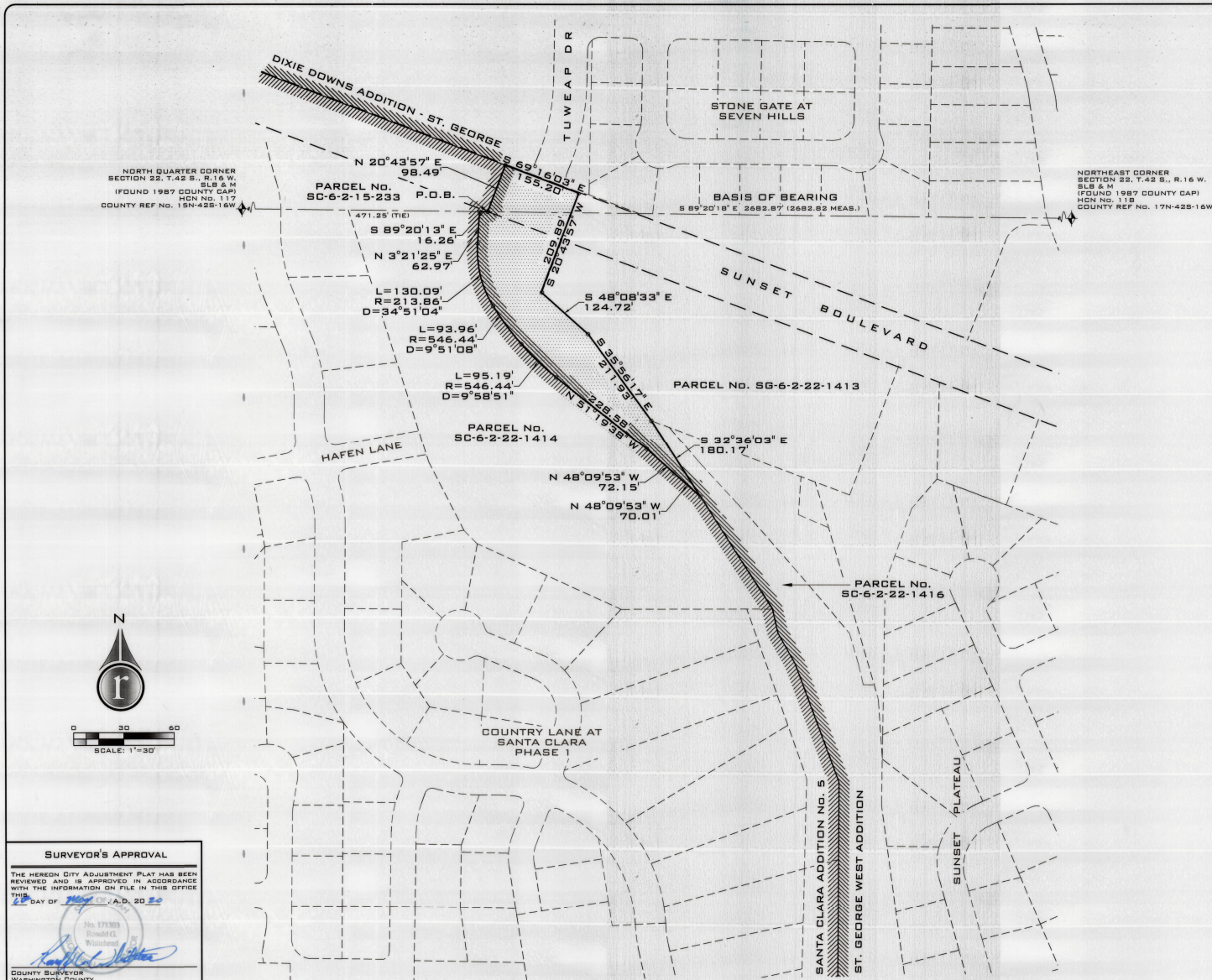

SURVEYOR'S CERTIFICATE:

I, BRANDON E. ANDERSON, PROFESSIONAL LAND SURVEYOR NUMBER 4938716, HOLD A LICENSE IN ACCORDANCE WITH TITLE 58, CHAPTER 22, PROFESSIONAL ENGINEERS AND LAND SURVEYORS LICENSING ACT AND HAVE COMPLETED A SURVEY OF THE PROPERTY DESCRIBED HEREIN IN ACCORDANCE WITH SECTION 17-23-17 AND HEREBY CERTIFY ALL MEASUREMENTS AND DESCRIPTIONS ARE CORRECT. I FURTHER CERTIFY THAT THIS MAP CORRECTLY REPRESENTS LANDS TO BE ADDED TO THE CITY OF ST. GEORGE, UTAH TO BE KNOWN AS THE SAND HOLLOW WASH ADJUSTMENT WHICH LANDS LIE IN THE NORTHEAST QUARTER OF SECTION 22, AND THE SOUTHEAST QUARTER OF SECTION 15, TOWNSHIP 42 SOUTH, RANGE 16 WEST, SALT LAKE BASE AND MERIDIAN, SAID LAND BEING SPECIFICALLY DESCRIBED AS FOLLOWS:

BEGINNING AT A POINT SOUTH 89°20'13" EAST 471.25 FEET ALONG THE SECTION LINE FROM THE NORTH QUARTER CORNER OF SECTION 22, TOWNSHIP 42 SOUTH, RANGE 16 WEST, SALT LAKE BASE & MERIDIAN, AND RUNNING:

THENCE NORTH 20°43'57" EAST 98.49 FEET TO THE SOUTHERLY LINE OF THE DIXIE DOWNS ADDITION; THENCE SOUTH 69°16'03" EAST 155.20 FEET ALONG SAID SOUTHERLY LINE OF SAID DIXIE DOWNS ADDITION AND TO AND ALONG THE NORTHERLY LINE OF THE SANTA CLARA ADDITION NO. 5; THENCE SOUTHERLY THE FOLLOWING (4) COURSES ALONG THE EASTERLY LINE OF SAID SANTA CLARA ADDITION NO. 5:
 THENCE SOUTH 20°43'57" WEST 209.89 FEET;
 THENCE SOUTH 48°08'33" EAST 124.72 FEET;
 THENCE SOUTH 35°56'17" EAST 211.95 FEET;
 THENCE SOUTH 33°30'03" EAST 180.17 FEET;
 THENCE NORTH 48°09'53" WEST 70.01 FEET;
 THENCE NORTH 48°09'53" WEST 72.15 FEET;
 THENCE NORTH 51°19'38" WEST 228.58 FEET;
 THENCE NORTHWEST 95.19 FEET ALONG AN ARC OF A 546.44 FOOT RADIUS CURVE TO THE RIGHT (CENTER BEARS NORTH 38°40'22" EAST, LONG CHORD BEARS NORTH 46°20'13" WEST 95.07 FEET WITH A CENTRAL ANGLE OF 09°58'11");
 THENCE NORTHWEST 93.96 FEET ALONG AN ARC OF A 546.44 FOOT RADIUS CURVE TO THE RIGHT (CENTER BEARS NORTH 42°59'13" EAST, LONG CHORD BEARS NORTH 36°25'13" WEST 93.85 FEET WITH A CENTRAL ANGLE OF 09°51'08");
 THENCE NORTH 130.09 FEET ALONG AN ARC OF A 213.85 FOOT RADIUS CURVE TO THE RIGHT (CENTER BEARS NORTH 58°30'21" EAST, LONG CHORD BEARS NORTH 14°04'07" WEST 128.09 FEET WITH A CENTRAL ANGLE OF 34°51'04");
 THENCE NORTH 03°21'25" EAST 62.97 FEET TO THE POINT OF BEGINNING.

CONTAINS 72,394 SQUARE FEET OR 1.66 ACRES.

3/9/2020
DATE

BRANDON E. ANDERSON



CERTIFICATE NO. 4938716

LEGEND

- NOTHING SET OR FOUND
- ◆ FOUND SECTION MONUMENTATION AS SHOWN AND DESCRIBED
- ▨ CITY OF ST. GEORGE MUNICIPAL LINE
- ▨ SANTA CLARA CITY MUNICIPAL LINE
- ▨ AREA REMOVED FROM SANTA CLARA CITY AND ADDED TO THE CITY OF ST. GEORGE

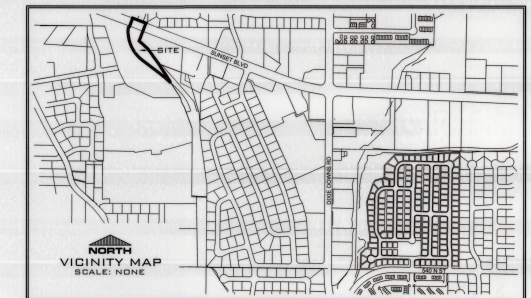

A MUNICIPAL BOUNDARY LINE ADJUSTMENT PLAT

SAND HOLLOW WASH ADJUSTMENT

AREA TO BE REMOVED FROM SANTA CLARA CITY AND ADDED TO THE CITY OF ST. GEORGE

LOCATED IN N.E. 1/4 OF SECTION 22, & S.E. 1/4 OF SECTION 15 TOWNSHIP 42 SOUTH, RANGE 16 WEST SALT LAKE BASE AND MERIDIAN WASHINGTON COUNTY, UTAH.

SURVEYOR'S APPROVAL
THE HEREIN CITY ADJUSTMENT PLAT HAS BEEN REVIEWED AND IS APPROVED IN ACCORDANCE WITH THE INFORMATION ON FILE IN THIS OFFICE THIS 11th DAY OF May, A.D. 2020
No. 171303
Ronald G. Wainwright
COUNTY SURVEYOR
WASHINGTON COUNTY

SURVEYOR'S APPROVAL	APPROVAL AS TO FORM	APPROVAL AND ACCEPTANCE BY THE CITY OF ST. GEORGE, UTAH	SURVEYOR'S APPROVAL	APPROVAL AS TO FORM	APPROVAL AND ACCEPTANCE BY THE SANTA CLARA CITY, UTAH	RECORDED NUMBER
THE HEREIN CITY ADJUSTMENT PLAT HAS BEEN REVIEWED AND IS APPROVED IN ACCORDANCE WITH THE INFORMATION ON FILE IN THIS OFFICE THIS 10th DAY OF May, A.D. 2020 CITY SURVEYOR CITY OF ST. GEORGE	APPROVED AS TO FORM, THIS THE 10th DAY OF May, A.D. 2020 CITY ATTORNEY CITY OF ST. GEORGE	WE, THE MAYOR AND CITY COUNCIL OF THE CITY OF ST. GEORGE, UT, HAVE REVIEWED THE ABOVE CITY ADJUSTMENT PLAT AND BY AUTHORIZATION OF SAID CITY COUNCIL, RECORD IN THE MINUTES OF ITS MEETING OF THE 11th DAY OF May, A.D. 2020 HEREBY ACCEPT SAID FINAL PLAT WITH ALL COMMITMENTS AND OBLIGATIONS PERTAINING THEREO. MAYOR CITY OF ST. GEORGE	THE HEREIN CITY ADJUSTMENT PLAT HAS BEEN REVIEWED AND IS APPROVED IN ACCORDANCE WITH THE INFORMATION ON FILE IN THIS OFFICE THIS 11th DAY OF May, A.D. 2020 CITY SURVEYOR SANTA CLARA CITY	APPROVED AS TO FORM, THIS THE 10th DAY OF May, A.D. 2020 CITY ATTORNEY SANTA CLARA CITY	WE, THE MAYOR AND CITY COUNCIL OF SANTA CLARA CITY, UT, HAVE REVIEWED THE ABOVE CITY ADJUSTMENT PLAT AND BY AUTHORIZATION OF SAID CITY COUNCIL, RECORD IN THE MINUTES OF ITS MEETING OF THE 11th DAY OF May, A.D. 2020 HEREBY ACCEPT SAID FINAL PLAT WITH ALL COMMITMENTS AND OBLIGATIONS PERTAINING THEREO. MAYOR SANTA CLARA CITY	WASHINGTON COUNTY RECORDER

ROSENBERG ASSOCIATES
CIVIL ENGINEERS • LAND SURVEYORS

352 EAST RIVERSIDE DRIVE, SUITE A-2 ST. GEORGE, UTAH 84790
PH (435) 673-8586 FX (435) 673-8397 • WWW.RADIVIL.COM

CITY LINE ADJ. 2/28/2019
FILE NUMBER: 11309-19
DATE: 11/30/19
SCALE: 1" = 150'
B.E.A. DRAWN:
B.E.A. CHECKED: