



OFFICE OF THE LIEUTENANT GOVERNOR  
CERTIFICATE OF CREATION

I, SPENCER J. COX, LIEUTENANT GOVERNOR OF THE STATE OF UTAH,  
HEREBY CERTIFY THAT there has been filed in my office a notice of creation of the  
EMERY EMERGENCY MEDICAL SPECIAL SERVICE DISTRICT, dated June 30<sup>th</sup>,  
2020, complying with Section 17D-1-209, Utah Code Annotated, 1953, as amended.

NOW, THEREFORE, notice is hereby given to all whom it may concern that the  
attached is a true and correct copy of the notice of creation, referred to above, on file with  
the Office of the Lieutenant Governor pertaining to the EMERY EMERGENCY  
MEDICAL SPECIAL SERVICE DISTRICT, located in Emery County, State of Utah.

IN TESTIMONY WHEREOF, I have  
hereunto set my hand, and affixed the Great  
Seal of the State of Utah this 20<sup>th</sup> day of  
July, 2020 at Salt Lake City, Utah.

A handwritten signature in black ink, appearing to read "Spencer J. Cox".

SPENCER J. COX  
Lieutenant Governor



UTAH LT. GOVERNOR'S OFFICE  
Utah State Capitol Complex  
350 North State Street, Suite 220  
P.O. Box 142325  
Salt Lake City, Utah 84114-2325

## NOTICE OF AN IMPENDING BOUNDARY ACTION

### *Emery Emergency Medical Special Service District*

Please take notice that the Emery County Commission (the "County") has adopted a Resolution establishing the creation of the "Emery Emergency Medical Special Service District" (the "District"). A copy of the Resolution is enclosed.

The geographic boundaries of the District shall be, and shall at all times automatically remain, coterminous with the geographic boundaries of the County. Any change in the boundaries of the County from time to time shall automatically and with no further action required constitute a corresponding change to the boundaries of the District.

The District has obtained a letter from the Utah State Retirement Office as provided in Section 67-1a-6.5(3)(d) of the Utah Code Ann.

As required by Section 67-1a-6.5 of the Utah Code Ann., we certify that the County has met all of the requirements for this action. Accordingly, we request that you issue a Certification of Creation pursuant to Sections 17c-1-201.5(2)(a)(ii) and 67-1a-6.5 of the Utah Code Ann.

DATED THIS 30 DAY OF June, 2020.

EMERY COUNTY COMMISSION



Lynn Sitterud, Commission Chairman

**RESOLUTION 6-02-2020A**

**A RESOLUTION TO ESTABLISH  
THE EMERY EMERGENCY MEDICAL SPECIAL SERVICE DISTRICT**

**WHEREAS**, the Board of County Commissioners (“Commission”) of Emery County, Utah, oversees a County Emergency Medical Service Entity with an Administrative Control Board having exclusive control and jurisdiction over Emery County emergency services; and

**WHEREAS**, the Commission wishes to relinquish and transfer such Entity to a newly created special service district; and

**WHEREAS**, the Commission believes that the public health, convenience and necessity require the establishment of the independent Emery Emergency Medical Special Service District (hereinafter “District”) to provide a greater level of emergency medical services, and therefore it is desirable to establish said District pursuant to the provisions of the Utah Special Service District Act, Utah Code Ann. §17D-1-101 *et seq.*, as amended; and

**WHEREAS**, the Commission adopted Intention Resolution No. 1-21-20B on January 21, 2020 in substantially the same form as this proposed Resolution; and

**WHEREAS**, all property within the boundaries of said District (described more particularly below), shall be benefitted by the addition of such services; and

**WHEREAS**, none of the area proposed for such services is also within the boundaries of any other special service district established by said County to provide such services.

**BE IT RESOLVED** by the Emery County Commission as follows:

**Section 1.**

The Commission has heretofore considered each and every protest filed and has heard each and every person who wished to be heard in protest against the establishment of the District and any other matter pertinent to the establishment of the District.

**Section 2.**

The Commission finds that pursuant to Utah Code Ann. §17D-1-204 and §17D-1-206, adequate time has passed to allow for the filing of any protests to the creation of the District, and an insufficient number of protests were filed to prevent the creation of the District.

**Section 3.**

The Commission declares that the public health, convenience, and necessity require the establishment of the *Emery Emergency Medical Special Service District* pursuant to the provisions of Utah Special Service District Act, Utah Code Ann. §17D-1-101 *et seq.*

**Section 4.**

The Commission designates the name of the proposed District as: *Emery Emergency Medical Special Service District*, in accordance with Utah Code Ann. §17D-1-203(3)(c).

**Section 5.**

The boundary of the District includes all of Emery County including participating incorporated municipalities. Exhibit A includes a map showing the boundaries of the *Emery Emergency Medical Special Service District*.

**Section 6.**

The establishment of the District as proposed and described in the Notice of Public Hearing and of Intention to Establish the District is hereby authorized, and the District is hereby created to provide the following services:

- Prehospital emergency medical services, including planning, operation, funding, and management of Paramedic and Ambulance services, both routine and emergent, including quick response units, inter-facility transport services, community Paramedicine and mobile integrated health services.

**Section 7.**

The District's status, powers, and duties are as follows:

- The District shall have all power and authority allowed by the Special Service District Act contained in the Utah Code unless otherwise prohibited by this Resolution.
- The District alone shall be responsible for all of the services undertaken solely by the District, without any recourse to the County or other local government entities. Notwithstanding the foregoing, the District, acting in its sole discretion, may at times cooperate with other local government entities and enter into contracts to carry out special service district functions as allowed by Utah Code Ann. §17D-1-103(2)(b) and to perform projects through Interlocal Agreements pursuant to Utah Code Ann. §11-13-101 *et seq.* If the District uses an officer, employee, property, equipment, office, or facility of Emery County, the District shall reimburse Emery County a reasonable amount for what the District uses subject to Utah Code Ann. §17D-1-103(2) and (3). The District shall avoid any

action that could jeopardize the perceived independence of the District from the County or other local government entities.

#### **Section 8.**

The District shall finance the above defined services, among other ways, through charges or fees for services rendered and, when allocated by the Commission, the rural health care sales and use tax, and transient room tax revenues as authorized by State law. Fees or charges may be imposed to pay for some or all of the services that the special service district is proposed to provide in allowance of the State Code. The District may receive Mineral Lease Funds as authorized by Utah Code Annotated §59-21-1.

The Commission may levy a tax upon the taxable property in the District if the levy has the prior approval of a majority of the registered voters of the District voting in an election held for that purpose under Title 11, Chapter 14, Local Government Bonding Act, in the same manner as for an election for the issuance of bonds.

#### **Section 9.**

The District shall be administered by an Administrative Control Board (hereinafter the “**Board**”), which is hereby delegated, without limitation, the power to act as the governing authority of the District and to exercise all or any of the powers provided in accordance with Utah Code Ann. §17D-1-301 unless otherwise stated in this Resolution.

#### **Section 10.**

The membership of the Board shall consist of three (3) to seven (7) members, each of whom is a registered voter of the District, but only one (1) of whom may be a member of the Emery County Commission, only one (1) of whom may be a member of each participating municipality with a garage as appointed by their council. All other board members shall be appointed by the Commission.

Two (2) of the Board members shall have an initial term of two (2) years, and two (2) of the Board members shall have terms of four (4) years. The Board members with the term of two (2) years shall be determined by choosing lots. After the conclusion of the first terms of office, all terms thereafter shall be four (4) year terms pursuant to Utah Code Ann. §17D-1-304(2) with terms ending on December 31st of each year. Appointments of Emery County Commission and each participating municipality Members shall each have terms on the Board consistent with their terms of office.

The Emery County Commission has considered the appointments to the Board that are most familiar with the needs of the District, which includes but is not limited to prehospital emergency medical service needs in Emery County.

The initial appointees and terms of the Board are as follows:

**Board Member Appointees**

**Term Ends**

_____	_____
_____	_____
_____	_____
_____	_____
_____	_____
_____	_____
_____	_____

The appointees are hereby appointed effective upon the date of issuance of the Certificate of Creation by the Lieutenant Governor. Commencement of District operations shall be on the effective date of transfer by resolution of the Entity to the District, whichever is later.

**Section 11.**

The members of the Board shall serve without compensation except that they may be reimbursed for reasonable expenses consistent with Utah Code Ann. §17D-1-305 and 17B-1-307.

**Section 12.**

The Board should create Bylaws in accordance with Utah Code Ann. §17B-1-301(2)(h) and 17B-1-310(1)(b).

**Section 13.**

Subject to Utah Code, the Emery County Commission may dissolve the District in accordance with the process contained in Utah Code Ann. §17D-1-601 through 603.

**Section 14.**

If any one or more sections, sentences, clauses or parts of this Resolution shall, for any reason, affect, impair or invalidate the remaining provisions of this Resolution, but shall be confined in its operation to the specific sections, sentences, clauses or parts of this Resolution so held unconstitutional and invalid, then such offending sections, sentences,

clauses or parts shall be severed, and shall not affect or prejudice in any way the applicability and validity of this Resolution in any other instances.

**Section 15.**

All resolutions, by-laws and regulations of Emery County, Utah, in conflict with this Resolution, are hereby repealed to the extent only of such inconsistency. This repeal shall not be construed to revive any resolution, by-law or regulations, or part thereof, heretofore repealed.

APPROVED this 2 day of June, 2020, by the following vote:

AYE: 

NAY: \_\_\_\_\_

ABSENT: \_\_\_\_\_

EMERY COUNTY COMMISSION

  
Lynn Sitterud, Commission Chairman

ATTEST:

  
Brenda Tuttle, Clerk/Auditor

**Exhibit A**

A map showing the boundaries of the *Emery Emergency Medical Special Service District*

# Emery County

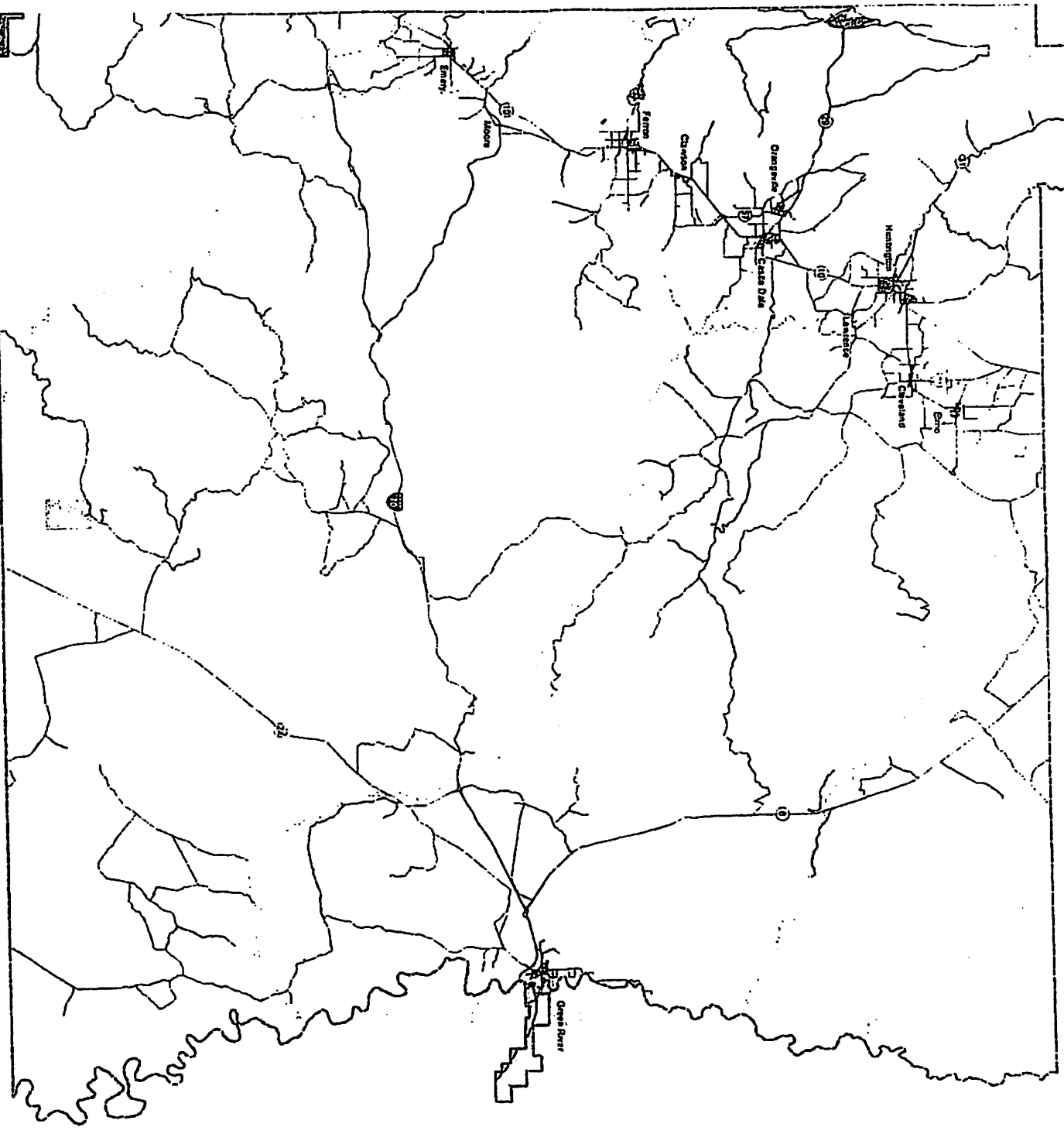
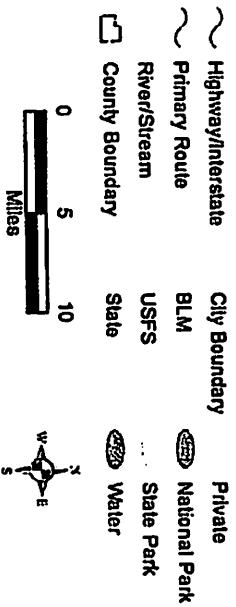

**Exhibit B**  
**Huntington City Inclusion Resolution**

HUNTINGTON CITY  
RESOLUTION 11-2020

**A RESOLUTION CONSENTING TO THE INCLUSION OF THE CITY OF HUNTINGTON WITHIN THE BOUNDARIES OF THE EMERY EMERGENCY MEDICAL SPECIAL SERVICE DISTRICT IN EMERY COUNTY, UTAH**

WHEREAS, the Emery County commission plans to establish a special service district known as the "Emery Emergency Medical Special Service District" (EEM District); and

WHEREAS, the Board has provided that the City shall be included within the boundaries of the EEM District, but a special service district established by a county may contain all or part of any municipality only with the consent of the governing authority of the municipality, as provided in a resolution duly adopted by the governing authority of the municipality;

WHEREAS, the Emery County commission offers to provide emergency services to any incorporated are of the County that wishes to participate.

WHEREAS, the City Council consents to the inclusion of the City within the boundaries of the EEM District at the time of creation of said EEM District; and

WHEREAS, the City Council of the City has determined that the public health, convenience and necessity requires the establishment of the EEM District.

THEREFORE, it is hereby resolved by the City Council of the City of Huntington hereby consents to the inclusion of the City within the Boundaries of the Huntington Emergency Medical Special Service District as established by the Emery County Commission.

THEREFORE, Huntington City will provide space in the Fire Station for the ambulance and it's supplies and will also provide office space for training and the keeping of paper work

This resolution shall take effect immediately upon passage.

Passed and adopted by action of the Governing Body of the City of Huntington in open session the  
20 day of May, 2020.

  
Mayor Leonard Norton

(SEAL)

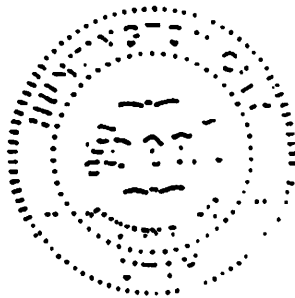

ATTEST:

  
Jenene Hansen, City Recorder

David Emery



Tom Key

Jerry Livingston

Lesa Miller

Gloria Wilson

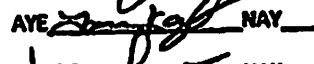
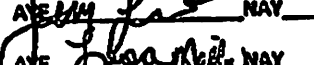
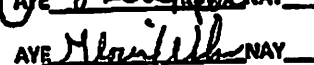
COUNCIL MEMBERS

AYE  NAY \_\_\_\_\_  
AYE  NAY \_\_\_\_\_  
AYE  NAY \_\_\_\_\_  
AYE  NAY \_\_\_\_\_  
AYE  NAY \_\_\_\_\_

**Exhibit C**

**Castle Dale City Inclusion Resolution**

RESOLUTION 5-14-2020 C

**A RESOLUTION CONSENTING TO THE INCLUSION OF THE CITY OF CASTLE DALE WITHIN THE BOUNDARIES OF THE EMERY EMERGENCY MEDICAL SPECIAL SERVICE DISTRICT IN EMERY COUNTY, UTAH**

**WHEREAS, the Emery County Commission plans to establish a special service district known as the "Emery Emergency Medical Special Service District" ("EEM District"); and**

**WHEREAS, the Board has provided that the City shall be included within the boundaries of the EEM District, but a special service district established by a county may contain all or part of any municipality only with the consent of the governing authority of the municipality, as provided in a resolution duly adopted by the governing authority of the municipality;**

**WHEREAS, the Emery County Commission offers to provide emergency services to any incorporated area of the County that wishes to participate.**

**WHEREAS, the City Council consents to the inclusion of the City within the boundaries of the EEM District at the time of creation of said EEM District; and**

**WHEREAS, the City Council of the City has determined that the public health, convenience and necessity requires the establishment of the EEM District.**

**THEREFORE, it is hereby resolved by the City Council of the City Of Castle Dale hereby consents to the inclusion of the City within the boundaries of the Emery Emergency Medical Special Service District as established by the Emery County Commission.**

**This resolution shall take effect immediately upon passage.**

**Passed and adopted by action of the Governing Body of the City of Castle Dale in open session this**

**14 day of May, 2020**

**CITY OF CASTLE DALE**



**Mayor**

**Attest**



**City Recorder**

**Exhibit D**  
**Cleveland Town Inclusion Resolution**

**RESOLUTION \_\_\_\_\_**

**A RESOLUTION CONSENTING TO THE INCLUSION OF THE TOWN OF CLEVELAND  
WITHIN THE BOUNDARIES OF THE EMERY EMERGENCY MEDICAL SPECIAL SERVICE  
DISTRICT IN EMERY COUNTY, UTAH**

**WHEREAS**, the Emery County Commission plans to establish a special service district known as the  
"Emery Emergency Medical Special Service District" ("EEM District"); and

**WHEREAS**, the Board has provided that the Town shall be included within the boundaries of the EEM  
District, but a special service district established by a county may contain all or part of any municipality  
~~only with the consent of the governing authority of the municipality~~, as provided in a resolution duly  
adopted by the governing authority of the municipality;

**WHEREAS**, the Emery County Commission offers to provide emergency services to any incorporated  
area of the County that wishes to participate.

**WHEREAS**, the Town Council consents to the inclusion of the Town within the boundaries of the EEM  
District at the time of creation of said EEM District; and

**WHEREAS**, the Town Council of the Town has determined that the public health, convenience and  
necessity requires the establishment of the EEM District.

**THEREFORE**, it is hereby resolved by the Town Council of the Town of Cleveland hereby consents to  
the inclusion of the City within the boundaries of the Emery Emergency Medical Special Service District  
as established by the Emery County Commission.

This resolution shall take effect immediately upon passage.

Passed and adopted by action of the Governing Body of the Town of Cleveland in open session this  
20 day of May, 2020.

TOWN OF CLEVELAND

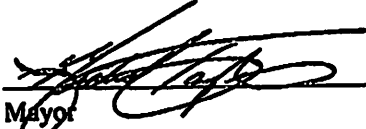
  
\_\_\_\_\_  
Mayor

ATTEST:

  
\_\_\_\_\_  
Cleveland, City Recorder



**Exhibit E**  
**Green River City Inclusion Resolution**

**RESOLUTION R02-2020**

**A RESOLUTION CONSENTING TO THE INCLUSION OF THE CITY OF GREEN RIVER  
WITHIN THE BOUNDARIES OF THE EMERY EMERGENCY MEDICAL SPECIAL SERVICE  
DISTRICT IN EMERY COUNTY, UTAH**

**WHEREAS**, the Emery County Commission plans to establish a special service district known as the "Emery Emergency Medical Special Service District" ("EEM District") and

**WHEREAS**, the Board has provided that the City shall be included within the boundaries of the EEM District, but a special service district established by a county may contain all or part of any municipality only with the consent of the governing authority of the municipality, as provided in a resolution duly adopted by the governing authority of the municipality; and

**WHEREAS**, the Emery County Commission offers to provide emergency services to any incorporated area of the County that wishes to participate; and

**WHEREAS**, the City Council consents to the inclusion of the City within the boundaries of the EEM District at the time of creation of said EEM District; and

**WHEREAS**, the City Council of the City has determined that the public health, convenience and necessity requires the establishment of the EEM District; and

**THEREFORE**, it is hereby resolved by the City Council of the City of Green River hereby consents to the inclusion of the City within the boundaries of the Emery Emergency Medical Special Service District as established by the Emery County Commission.

This resolution shall take effect immediately upon passage.

Passed and adopted by action of the Governing Body of the City of Green River in open session this 28 day of May, 2020.

City of Green River

Travis Bacon

Mayor, Travis Bacon

ATTEST:

Conae Black

Conae Black, City Recorder

**Exhibit F**  
**Orangeville City Inclusion Resolution**

RESOLUTION 2020-2

**A RESOLUTION CONSENTING TO THE INCLUSION OF THE CITY OF ORANGEVILLE  
WITHIN THE BOUNDARIES OF THE EMERY EMERGENCY MEDICAL SPECIAL SERVICE  
DISTRICT IN EMERY COUNTY, UTAH**

**WHEREAS**, the Emery County Commission plans to establish a special service district known as the "Emery Emergency Medical Special Service District" ("EEM District"); and

**WHEREAS**, the Board has provided that the City shall be included within the boundaries of the EEM District, but a special service district established by a county may contain all or part of any municipality only with the consent of the governing authority of the municipality, as provided in a resolution duly adopted by the governing authority of the municipality;

**WHEREAS**, the Emery County Commission offers to provide emergency services to any incorporated area of the County that wishes to participate.

**WHEREAS**, the City Council consents to the inclusion of the City within the boundaries of the EEM District at the time of creation of said EEM District; and

**WHEREAS**, the City Council of the City has determined that the public health, convenience and necessity requires the establishment of the EEM District.

**THEREFORE**, it is hereby resolved by the City Council of the City of Orangeville hereby consents to the inclusion of the City within the boundaries of the ~~Green River~~ <sup>Emery</sup> Emergency Medical Special Service District as established by the Emery County Commission.

This resolution shall take effect immediately upon passage.

Passed and adopted by action of the Governing Body of the City of Orangeville in open session this 14<sup>th</sup> day of May, 2020.

CITY OF ORANGEVILLE

Roger Swenson  
Mayor

ATTEST:

Maeagan Wilber  
maeagan wilber City Recorder



**Exhibit G**  
**Ferron City Inclusion Resolution**

RESOLUTION 2020-4

**A RESOLUTION CONSENTING TO THE INCLUSION OF THE CITY OF FERRON WITHIN  
THE BOUNDARIES OF THE EMERY EMERGENCY MEDICAL SPECIAL SERVICE  
DISTRICT IN EMERY COUNTY, UTAH**

**WHEREAS**, the Emery County Commission plans to establish a special service district known as the "Emery Emergency Medical Special Service District" ("EEM District"); and

**WHEREAS**, the Board has provided that the City shall be included within the boundaries of the EEM District, but a special service district established by a county may contain all or part of any municipality only with the consent of the governing authority of the municipality, as provided in a resolution duly adopted by the governing authority of the municipality;

**WHEREAS**, the Emery County Commission offers to provide emergency services to any incorporated area of the County that wishes to participate.

**WHEREAS**, the City Council consents to the inclusion of the City within the boundaries of the EEM District at the time of creation of said EEM District; and

**WHEREAS**, the City Council of the City has determined that the public health, convenience and necessity requires the establishment of the EEM District.

**THEREFORE**, it is hereby resolved by the City Council of the City of Ferron hereby consents to the inclusion of the City within the boundaries of the Emery Emergency Medical Special Service District as established by the Emery County Commission.

--- This resolution shall take effect immediately upon passage.

Passed and adopted by action of the Governing Body of the City of Ferron in open session this 13<sup>th</sup> day of May, 2020.

CITY OF FERRON

Adele Justice

Mayor

ATTEST:

B Y A  
Ferron City, City Recorder



**Exhibit H**  
**Elmo Town Inclusion Resolution**

RESOLUTION 06-01-20A

**A RESOLUTION CONSENTING TO THE INCLUSION OF THE TOWN OF ELMO WITHIN  
THE BOUNDARIES OF THE EMERY EMERGENCY MEDICAL SPECIAL SERVICE  
DISTRICT IN EMERY COUNTY, UTAH**

WHEREAS, the Emery County Commission plans to establish a special service district known as the "Emery Emergency Medical Special Service District" ("EEM District"); and

WHEREAS, the Board has provided that the Town shall be included within the boundaries of the EEM District, but a special service district established by a county may contain all or part of any municipality only with the consent of the governing authority of the municipality, as provided in a resolution duly adopted by the governing authority of the municipality;

WHEREAS, the Emery County Commission offers to provide emergency services to any incorporated area of the County that wishes to participate.

WHEREAS, the Town Council consents to the inclusion of the Town within the boundaries of the EEM District at the time of creation of said EEM District; and

WHEREAS, the Town Council of the Town has determined that the public health, convenience and necessity requires the establishment of the EEM District.

THEREFORE, it is hereby resolved by the Town Council of the Town of Elmo hereby consents to the inclusion of the City within the boundaries of the Emery Emergency Medical Special Service District as established by the Emery County Commission.

This resolution shall take effect immediately upon passage.

Passed and adopted by action of the Governing Body of the Town of Elmo in open session this 43  
day of JUNE, 2020.



TOWN OF ELMO

\_\_\_\_\_  
Mayor

\_\_\_\_\_  
City Recorder

**Exhibit I**  
**Clawson Town Inclusion Resolution**

RESOLUTION 05-14-2020 A

**A RESOLUTION CONSENTING TO THE INCLUSION OF THE TOWN OF CLAWSON  
WITHIN THE BOUNDARIES OF THE EMERY EMERGENCY MEDICAL SPECIAL SERVICE  
DISTRICT IN EMERY COUNTY, UTAH**

**WHEREAS**, the Emery County Commission plans to establish a special service district known as the "Emery Emergency Medical Special Service District" ("EEM District"); and

**WHEREAS**, the Board has provided that the Town shall be included within the boundaries of the EEM District, but a special service district established by a county may contain all or part of any municipality only with the consent of the governing authority of the municipality, as provided in a resolution duly adopted by the governing authority of the municipality;

**WHEREAS**, the Emery County Commission offers to provide emergency services to any incorporated area of the County that wishes to participate.

**WHEREAS**, the Town Council consents to the inclusion of the Town within the boundaries of the EEM District at the time of creation of said EEM District; and

**WHEREAS**, the Town Council of the Town has determined that the public health, convenience and necessity requires the establishment of the EEM District.

**THEREFORE**, it is hereby resolved by the Town Council of the Town of Clawson hereby consents to the inclusion of the City within the boundaries of the Emery Emergency Medical Special Service District as established by the Emery County Commission.

This resolution shall take effect immediately upon passage.

Passed and adopted by action of the Governing Body of the Town of Clawson in open session this  
14 day of MAY, 2020.

TOWN OF CLAWSON

Dan P.  
Mayor

ATTEST:

Margaret Westland  
Clawson, City Recorder

**Exhibit J**  
**Emery Town Inclusion Resolution**

**A RESOLUTION CONCERNING TO THE INCLUSION OF THE TOWN OF EMERY  
WITHIN THE BOUNDARIES OF THE EMERY EMERGENCY MEDICAL SPECIAL  
SERVICE DISTRICT IN EMERY COUNTY, UTAH**

**WHEREAS**, The Emery County Commission plans to establish a special service district known as the "Emery Emergency Medical Special Service District" (EEM District"); and

**WHEREAS**, the Board has provided that the Town shall be included within the boundaries of the EEM District, but a special service district established by a county may contain all or part of any municipality only with the consent of the governing authority of the municipality, as provided in a resolution duly adopted by the governing authority of the municipality:

**WHEREAS**, the Emery County Commission offers to provide emergency services to any incorporated area of the County that wishes to participate.

**WHEREAS**, The Town Council consents to the inclusion of the Town within the boundaries of the EEM District at the time of creation said EEM District; and

**WHEREAS**, THE Town Council of the Town has determined that the public health, convenience and necessity requires the establishment of the EEM District.

**THEREFORE**, IT IS HEREBY RESOLVED BY THE Town Council of the Town of Emery hereby consents to the inclusion of the City within the boundaries of the Emery Emergency Medical Special Service District as established by the Emery County Commission.

This resolution shall take effect immediately upon passage

Passed and adopted by action of the Governing Body of the Town of Emery in open session this 13<sup>th</sup> day of May, 2020.

Town of Emery

  
Mayor

ATTEST:

 City, Recorder



## Utah Retirement Systems

### Retirement Office

560 East 200 South | Salt Lake City, UT 84102-2021  
801-366-7700 | 800-365-8772 | Fax: 801-366-7734  
[www.urs.org](http://www.urs.org)

Daniel D. Andersen  
*Executive Director*

### PEHP Health & Benefits

560 East 200 South | Salt Lake City, UT 84102-2004  
801-366-7500 | 800-365-8772 | Fax: 801-366-7596  
[www.pehp.org](http://www.pehp.org)

R. Chet Loftis  
*Managing Director*

July 2, 2020

**Sent via email to: Mary Huntington at [MaryH@emery.utah.gov](mailto:MaryH@emery.utah.gov)**

Lynn Sitterud, Commission Chairman  
Emery Emergency Medical Special Service District  
P.O. Box 629  
Castle Dale, UT 84513

**RE: Eligibility for Participation of a Newly Created Entity in the Utah State Retirement Systems**

Dear Lynn Sitterud:

When a governmental entity is being incorporated or created, Utah law requires the Utah State Retirement Office ("Office") to provide a letter to that entity identifying the potential provisions under Utah Code Title 49, Utah State Retirement and Insurance Benefit Act ("Retirement Act"), with which it shall comply. See Utah Code Ann. § 67-1a-6.5(3)(d). This letter serves as the official notice for Emery Emergency Medical Special Service District, a newly created special service district.

Based upon the information provided, the Office has determined that Emery Emergency Medical Special Service District is an "employer" under the Retirement Act as a political subdivision of the state by virtue of its status as a special service district. Accordingly, Emery Emergency Medical Special Service District must comply with the participation requirements of the Retirement Act.

This does not mean that Emery Emergency Medical Special Service District must provide retirement benefits to its employees. However, at the present time and throughout the future, Emery Emergency Medical Special Service District **is required by law to participate with URS if and when it offers any type of retirement benefit to its employees.**

Emery Emergency Medical Special Service District may not currently have employees or may have not yet elected to provide a retirement benefit to its employees. Please be aware, it is not the obligation of the Office to monitor the activities of Emery Emergency Medical Special Service District. **By law, it is Emery Emergency Medical Special Service District's obligation to apply for membership with URS if and when it chooses to provide a retirement benefit to its employees.**

Once Emery Emergency Medical Special Service District begins participation with URS, its public employees will be covered under either the Tier I or Tier II public employee retirement systems, as described in the Retirement Act. If Emery Emergency Medical Special Service

District employs public safety or firefighter service employees, those employees will be covered under the separate Tier I or Tier II systems for public safety and/or firefighter service employees described in the Retirement Act.

In addition, Participating Employers of URS are required by Utah Code Ann. § 49-11-606 to "cover all employees eligible for service credit under this title." As such, once admitted as a participating employer, Emery Emergency Medical Special Service District will be required to cover all eligible employees, pursuant to the eligibility rules found in the Retirement Act.

Please note that the above-referenced laws are those used to determine eligibility for participation and are not the only laws with which a participating employer must comply. Participating employers are required to "inform themselves of their rights and obligations" under Title 49 and should become familiar with all provisions of the Retirement Act. Once Emery Emergency Medical Special Service District is admitted into the system, URS provides education about the requirements with which Emery Emergency Medical Special Service District must comply as a participating employer.

Additionally, please be aware that should Emery Emergency Medical Special Service District fail to participate with URS while offering another retirement benefit to its employees, Emery Emergency Medical Special Service District's employees may have a claim against it for service credit under the Retirement Act, which the Office is required to enforce. Under the Retirement Act, such a claim would include all past employer contributions, interest, and in some cases, penalties. See Utah Code Ann. § 49-11-601(3).

Please do not hesitate to contact me if you have any questions.

Sincerely,

/s/ Daniel D. Andersen

Daniel D. Andersen  
Executive Director  
Utah State Retirement Office

EMERY EMERGENCY MEDICAL  
SPECIAL SERVICE DISTRICT  
EMERY COUNTY, UTAH

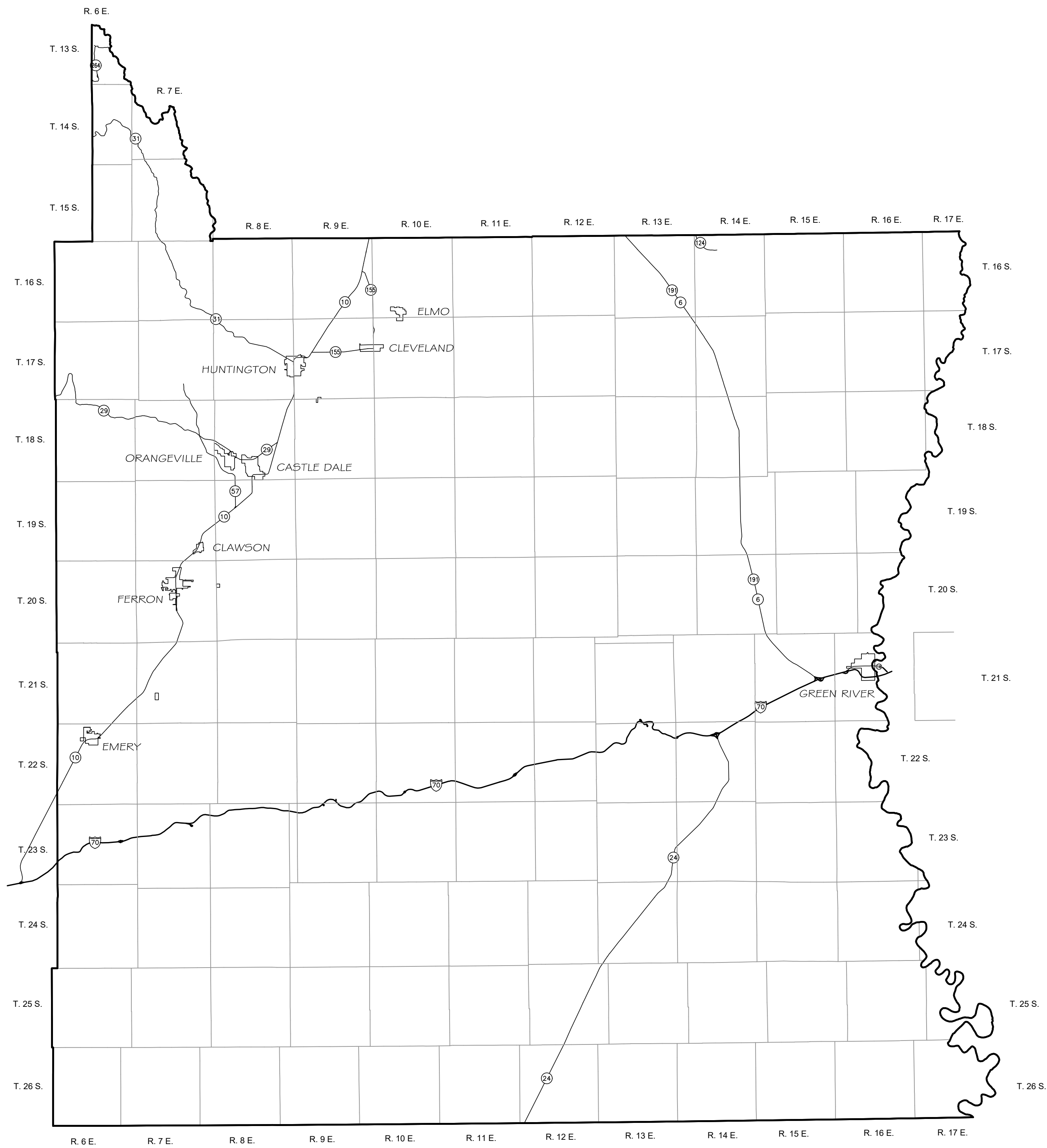

- LEGEND:
- EMERY EMERGENCY MEDICAL SPECIAL SERVICE DISTRICT BOUNDARY (SAME AS EMERY COUNTY BOUNDARY)
  - TOWNSHIP AND RANGE LINES
  - INTERSTATE HIGHWAYS
  - STATE HIGHWAYS

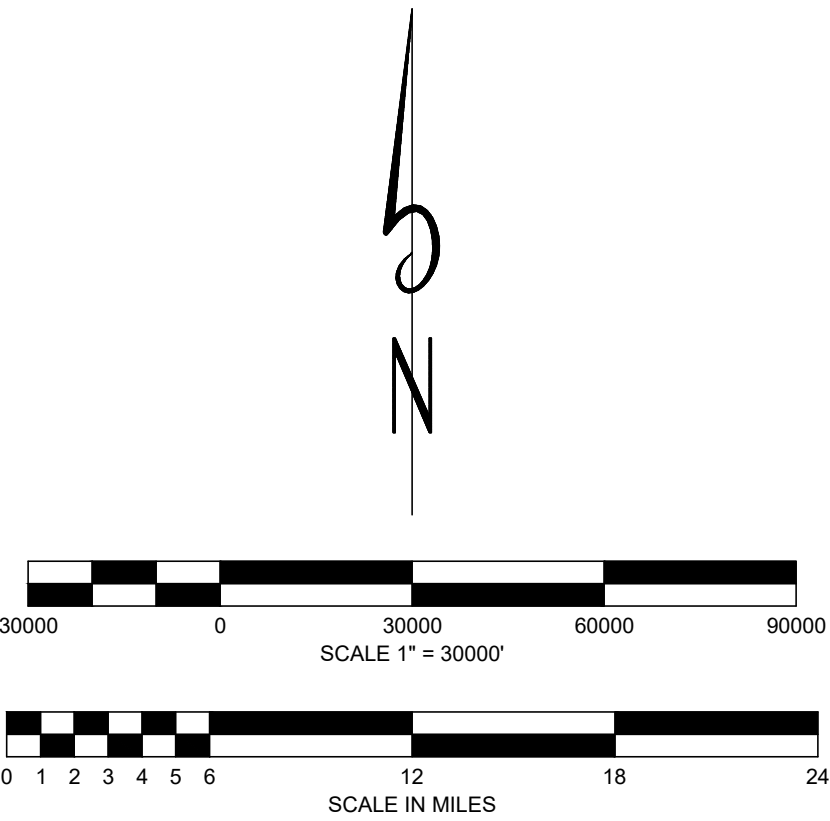

PREPARED BY:  
Johansen & Tuttle  
ENGINEERING, INC.  
P.O. Box 487, Castle Dale, UT 84513  
(435) 381-2523 Fax (435) 381-2522  
e-mail jt@etv.net, jandtengineering.com

NOTE:  
NO FIELD SURVEY WAS CONDUCTED.

SURVEYOR'S CERTIFICATE

I HEREBY CERTIFY THAT THIS IS A TRUE AND ACCURATE MAP OF THE BOUNDARY OF THE EMERY EMERGENCY MEDICAL SPECIAL SERVICE DISTRICT, EMERY COUNTY, UTAH.

WACEY R. ALLRED  
7-2-20  
DATE

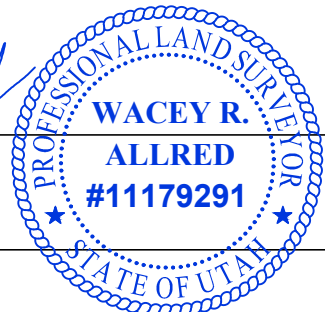

BOUNDARY DESCRIPTION

The geographic boundaries of Emery County are described as follows:  
Beginning at the intersection of the third standard parallel south with the middle of the main channel of the Green River; thence West to the summit of the watershed next East of Huntington Creek; thence northwesterly along said summit to the Section Line running North and South through the middle of Range 6 East; thence South to the third standard parallel South; thence West, to the line between Ranges 5 and 6 East; thence South to parallel 38°30' North Latitude; thence East, to the middle of the main channel of the Green River; thence northerly up the middle of said channel to the south line of Section 15, Township 21 South, Range 16 East; thence East, 4522.2 feet along the south line of Section 15 to the Southeast Corner of Section 15; thence East, 3969.9 feet along the south line of Section 14 to the Southwest Corner of the Southeast Quarter of the Southeast Quarter of Section 14; thence North, 1320 feet along the west line of the Southeast Quarter of the Southeast Quarter of Section 14 to the Northwest Corner of the Southeast Quarter of the Southeast Quarter of Section 14; thence East, 1323.3 feet along the north line of the Southeast Quarter of the Southeast Quarter of Section 14 to the Northwest Corner of the South Half of the Southwest Quarter of Section 13; thence East, 2648.2 feet along the north line of the South Half of the Southwest Quarter of Section 13; thence South, 1320.0 feet along the Quarter Section Line to the South Quarter Corner of Section 13; thence East, 2648.2 feet along the south line of Section 13 to the Southeast Corner of Section 13; thence South, along Section Line to the Southwest Corner of Section 18, Township 21 South, Range 17 East; thence N 89°56' E, 5078.0 feet to the Southeast Corner of Section 18; thence N 89°57" E, 2640.0 feet along the Section Line to the South Quarter Corner of Section 17; thence S 00°03' E, 5280.0 feet to the South Quarter Corner of Section 20; thence N 89°55' E, 2640.6 feet along the Section Line to the Southwest Corner of Section 20; thence N 89°57' E, 2639.3 feet along the Section Line to the South Quarter Corner of Section 21; thence S 00°02' E, 2640.0 feet along the Quarter Section Line to the Center Corner of Section 28; thence N 89°57' E, 2640.0 feet along the Quarter Section Line to the East Quarter Corner of Section 28; thence S 00°02' E, 2640.0 feet along the Section Line to the Southwest Corner of Section 27; thence N 89°57' E, 5283.9 feet along the Section Line to the Southeast Corner of Section 27; thence N 89°57' E, 5277.4 feet along the Section Line to the Southeast Corner of Section 26; thence N 00°01' W, 5280 feet along the Section Line to the Northeast Corner of Section 26; thence S 89°58' W, 5281.3 feet along the Section Line to the Northwest Corner of Section 26; thence N 00°01' W, 5280.0 feet along the Section Line to the Northeast Corner of Section 22; thence N 89°58' W, 5278.7 feet along the Section Line to the Northwest Corner of Section 22; thence N 00°02' W, 5280.0 feet along the Section Line to the Northeast Corner of Section 16; thence S 89°55' W, 5294.5 feet along the Section Line to the Northwest Corner of Section 16; thence S 00°03' E, 2640.0 feet along the Section Line to the West Quarter Corner of Section 16; thence S 89°57' W, 5280.7 feet along the Quarter Section Line to the West Quarter Corner of Section 17; thence S 89°56' W, 5078.7 feet along the Quarter Section Line to the West Quarter Corner of Section 18; thence North along the Section Line to the East Quarter Corner of Section 13, Township 21 South, Range 16 East; thence North along the east line of Section 13 and Section 12 to the East Quarter Corner of Section 12, Township 21 South, Range 16 East; thence West, 5312.3 feet along the Quarter Section Line to the East Quarter Corner of Section 11; thence West 5311.7 feet along the Quarter Section Line to the West Quarter Corner of Section 11; thence S 2640.0 feet along the west line of said Section 11 to the Southwest Corner of Section 11; thence East, 1618.4 feet along the Section Line to a point on the north line of Section 15; thence Northwest, 1058.5 feet along a line 400.0 feet North and parallel with the north right-of-way line of US Highway 6 and 50 to a point 277.0 feet North of the South Quarter Corner of Section 10; thence North, 59.0 feet along the Quarter Section Line; thence Northwest, 1350 feet along a line 400.0 feet North and parallel with the north right-of-way line of US Highway 6 and 50 to a point 400.0 feet North of the north right-of-way line of US Highway 6 and 50; thence N 548.2 feet; thence West, 689.0 feet; thence N 1550.8 feet parallel with and 647.76 feet East of the west line of Section 10 to the middle of the main channel of the Green River; thence Northerly up the middle of said channel to the point of beginning.

BOUNDARY PLAT OF THE  
EMERY EMERGENCY MEDICAL  
SPECIAL SERVICE DISTRICT  
EMERY COUNTY, UTAH

COUNTY SURVEYOR APPROVAL

I CERTIFY THAT I HAVE EXAMINED THIS FINAL LOCAL ENTITY PLAT AND THIS PLAT IS TECHNICALLY CORRECT AND MEETS THE REQUIREMENTS OF STATE STATUTE 17-23-2001.  
APPROVED THIS 6th DAY OF JULY 2020

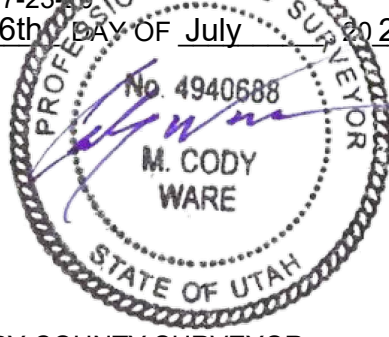

CONTRACT EMERY COUNTY SURVEYOR

COUNTY RECORDER