

STATE OF UTAH



OFFICE OF THE LIEUTENANT GOVERNOR
CERTIFICATE OF ANNEXATION

I, SPENCER J. COX, LIEUTENANT GOVERNOR OF THE STATE OF UTAH, HEREBY CERTIFY THAT there has been filed in my office a notice of annexation from the MOUNTAIN REGIONAL WATER SPECIAL SERVICE DISTRICT, dated December 4, 2020, complying with Section 17D-1-403, Utah Code Annotated, 1953, as amended.

NOW, THEREFORE, notice is hereby given to all whom it may concern that the attached is a true and correct copy of the notice of annexation, referred to above, on file with the Office of the Lieutenant Governor pertaining to MOUNTAIN REGIONAL WATER SPECIAL SERVICE DISTRICT located in Summit County, State of Utah.



IN TESTIMONY WHEREOF, I have hereunto set my hand, and affixed the Great Seal of the State of Utah this 16th day of December, 2020 at Salt Lake City, Utah.

A handwritten signature in black ink, appearing to read "Spencer J. Cox".

SPENCER J. COX
Lieutenant Governor

Notice of Impending Boundary Action

Pursuant to Utah Code Annotated §67-1a-6.5, the County Council of Summit County hereby provides the Lieutenant Governor's Office with written notice of an impending boundary action that effects Summit County and the Mountain Regional Water Special Service District.

The Summit County Council seeks a certificate of annexation as it relates to the Mountain Regional Water Special Service District. On November 23, 2020, the Summit County Council adopted Resolution MRW 2020-23 to annex certain property, Summit County Tax Parcel Number LVDAM-LV6A-AM-X, into the boundaries of the Mountain Regional Water Special Service District. Said parcel is solely owned by Summit County as set forth in the resolution.

The Summit County Council hereby certifies that the attached constitutes a true and correct copy of the Resolution annexing territory into the boundaries of the Mountain Regional Water Special Service District as well as the final local entity plat. The Summit County Council further certifies that all the requirements for the annexation of territory into the boundaries of the Mountain Regional Water Special Service District have been complied with pursuant to Utah Code Annotated §17D-1-101 et. seq.

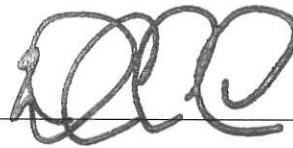

CHAIRPERSON OF THE SUMMIT COUNTY COUNCIL

IN WITNESS WHEREOF, I have hereunto set my hand and affixed the corporate seal of said County this 4th day of December 4, 2020.

COUNTY CLERK

RESOLUTION NO. MRW 2020-23

**A RESOLUTION ANNEXING CERTAIN REAL PROPERTY TO THE MOUNTAIN
REGIONAL WATER SPECIAL SERVICE DISTRICT
(LVDAM-LV6A-AM-X)**

WHEREAS, Summit County established a local district designated as the Mountain Regional Water Special Service District (the "District"), to provide water services within its boundaries; and

WHEREAS, Utah Code §17D-1-401 provides that additional land from that specified in the resolution establishing a local district may be annexed to the District in conformance with the applicable procedures; and

WHEREAS, Utah §17D-1-203 and §17D-1-401(2) provide that the County Council of Summit County, Utah (the "Council"), may be petitioned to annex an area into the District; and

WHEREAS, there have been numerous annexations into the District since its establishment in 1987; and

WHEREAS, Summit County, in its capacity as a land owner, has petitioned the Council to annex its land into the District (the "Petition"). In the Petition, Summit County represented that it is the sole owner of Summit County Tax Identification Parcel No. LVDAM-LV6A-AM-X; and

WHEREAS, the Summit County Clerk has certified the Petition; and

WHEREAS, Utah Code §17D-1-402 provides that the notice, hearing, and protest period do not apply if a petition for annexation of additional area is filed with the signatures of all of the owners of taxable real property; and

WHEREAS, Summit County through its County Manager has signed the Petition for annexation.

NOW, THEREFORE, BE IT RESOLVED by the Summit County Council as follows:

Section 1. **FINDINGS.** The Council finds and determines that public health, convenience, and necessity requires that certain land situated in Summit County, State of Utah, being generally described as Summit County Tax Identification Parcel No. LVDAM-LV6A-AM-X (the "Property") located in Summit County, Utah be annexed into the District.

Section 2. **ANNEXATION.** The Property is hereby annexed into the boundaries of Mountain Regional Water Special Service District. The Property so annexed shall be governed by and become an integral part of the District. Pursuant to this resolution (the "Resolution"), the owners of the Property shall be entitled, upon entering into a Water Service Agreement with the District, to receive the benefit of water services and facilities provided by the District, and shall be subject to the rights, powers and authority of the District, including, without limitation, the right, power and authority to promulgate rules and regulations for the operation of the District, to levy ad valorem taxes on the Property, and to impose such fees and charges as shall be necessary to pay for all or part of the commodities, facilities and services to be provided by the District for the payment of the District's bonds and other obligations.

Section 3. **Direction.** All officers and employees of the District are hereby directed to take such action as shall be necessary and appropriate to effectuate the provisions of this Resolution and the intent expressed herein.

Section 4. Effective Date. This Resolution shall take effect immediately upon its approval and adoption by the Council.

APPROVED AND ADOPTED this 23rd day of November, 2020

SUMMIT COUNTY COUNCIL
SUMMIT COUNTY, UTAH

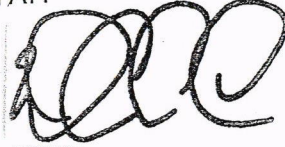

Doug Clyde
Chair

ATTEST:

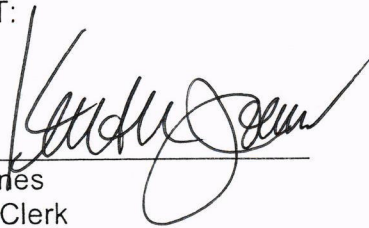

Kent Jones
County Clerk



APPROVED AS TO FORM:

David L. Thomas

David L. Thomas
Chief Civil Deputy

Exhibit A: Description of Property

Parcel LV6A, LOWER VILLAGE DEVELOPMENT AREA MASTER PLAT AMENDMENT TO LV6, according to Official Plat thereof, on file and of record in the Summit County Recorder's Office.

Tax ID: LVDAM-LV6A-AM-X

ANNEXATION TO MOUNTAIN REGIONAL WATER SPECIAL SERVICE DISTRICT PARCEL LVDAM-LV6A-AM-X BY RESOLUTION NO. 2020- MRW

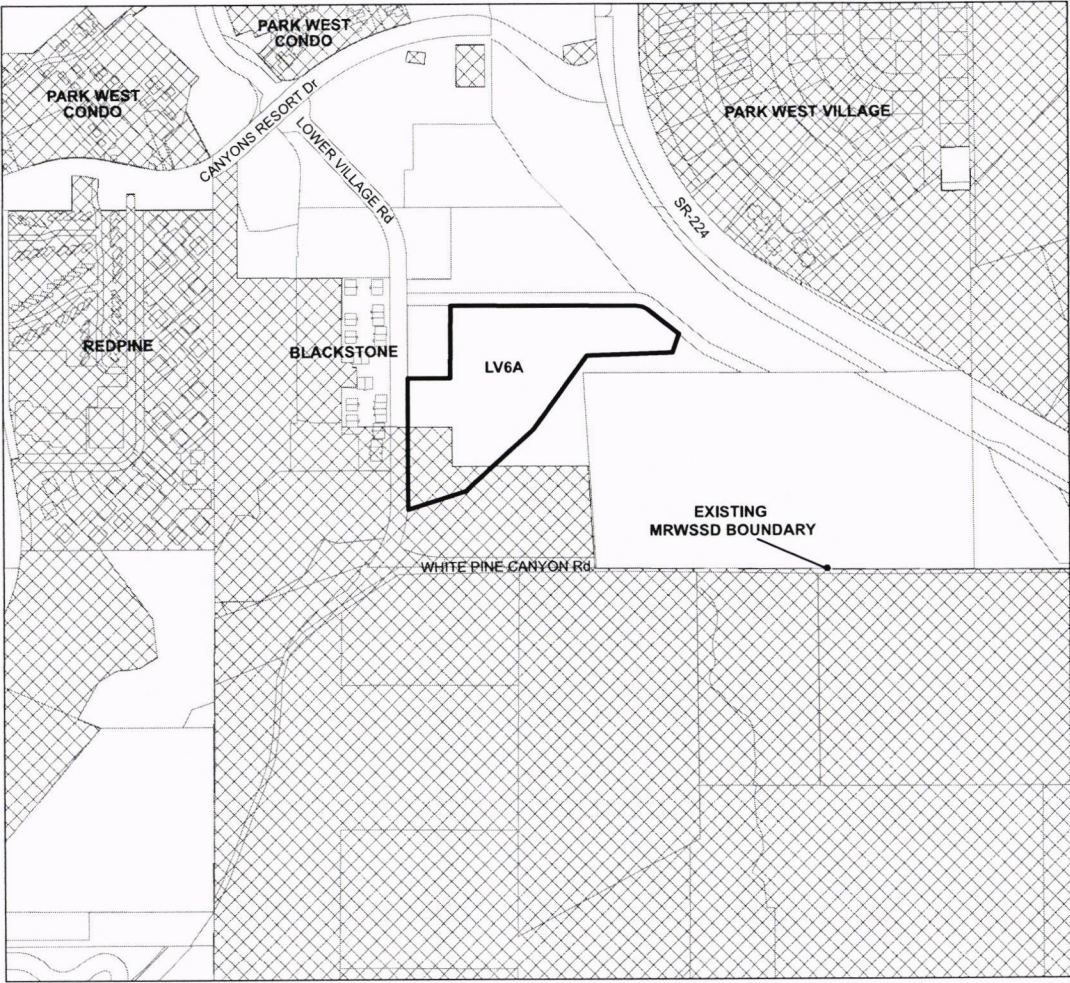

Legal Description:

Parcel LV6A, Lower Village Development Area Master Plat Amendment to LV6, according to the Official Plat thereof, on file and of record in the Summit County Recorder's Office.
Parcel ID LVDAM-LV6A-AM-X

SURVEYORS CERTIFICATE

I, Christopher Braun, do hereby certify that I am a licensed land surveyor and I hold license number 5152604 as prescribed under the laws of the State of Utah. I further certify that this plat has been made under my direction in compliance with Section 17A-2-1326(4) and that the annexation to Mountain Regional Water Special Service District is correctly shown hereon.
No field survey was performed in the creation of this plat.

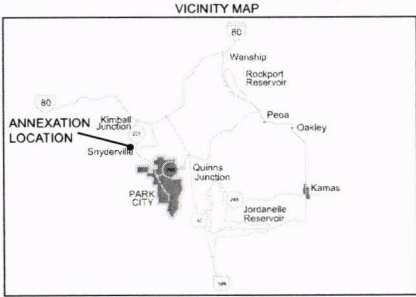

**Mountain Regional Water
Special Service District**



By C. Braun
Date: 5/7/2020

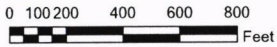

1 inch = 200 feet

APPROVED AS TO FORM SUMMIT COUNTY ATTORNEY BY _____ DATE _____	APPROVED AS TO FORM SUMMIT COUNTY SURVEYOR	COUNTY SURVEYOR FILING	SUMMIT COUNTY RECORDER
--	---	------------------------	------------------------

ANNEXATION TO MOUNTAIN REGIONAL WATER SPECIAL SERVICE DISTRICT PARCEL LVDAM-LV6A-AM-X BY RESOLUTION NO. 2020-23 MRW

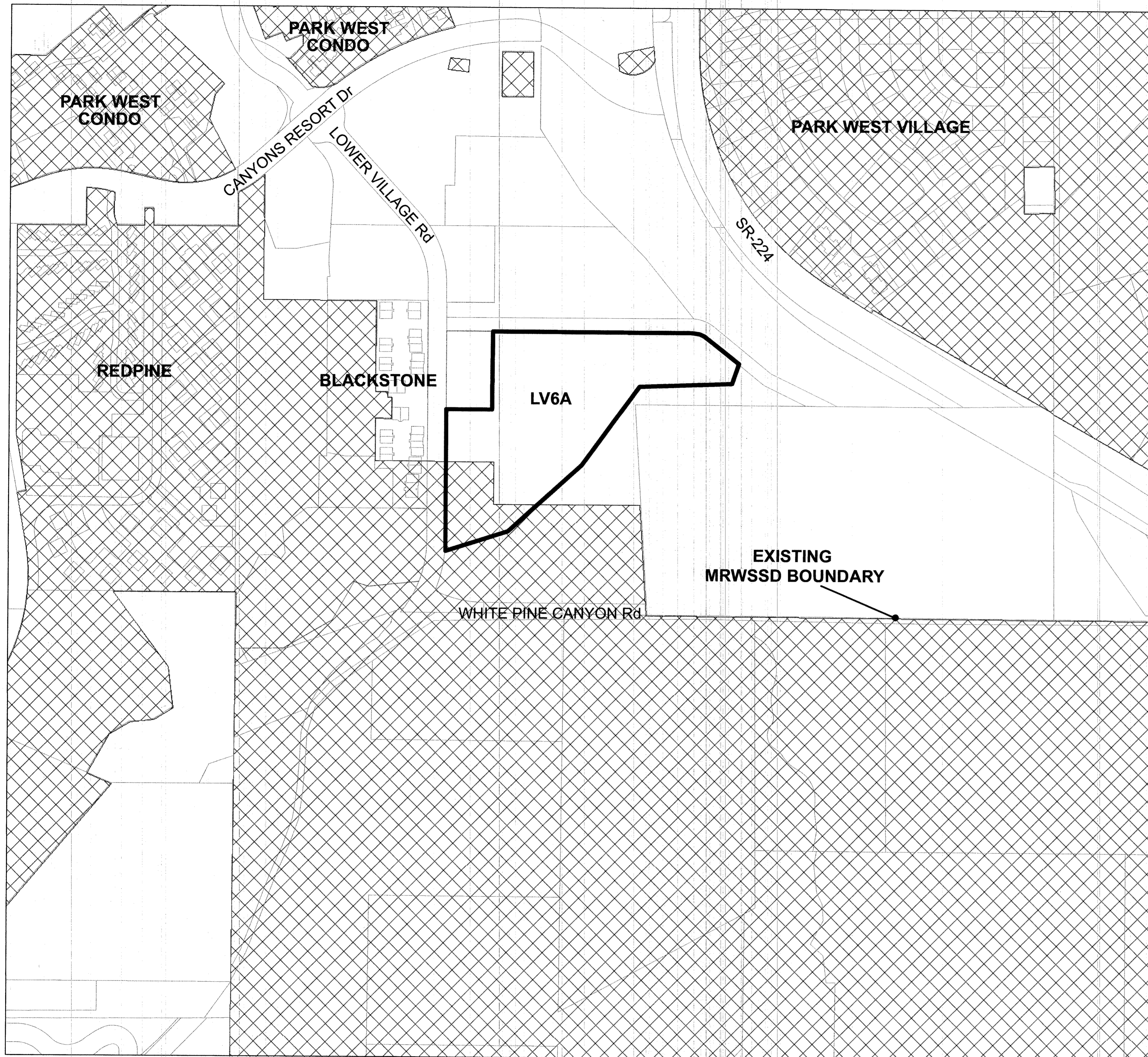

Legal Description:

Parcel LV6A, Lower Village Development Area Master Plat Amendment to LV6, according to the Official Plat thereof, on file and of record in the Summit County Recorder's Office.

Parcel ID LVDAM-LV6A-AM-X

SURVEYORS CERTIFICATE

I, Christopher Braun, do hereby certify that I am a licensed land surveyor and I hold license number 5152604 as prescribed under the laws of the State of Utah. I further certify that this plat has been made under my direction in compliance with Section 17A-2-1326(4) and that the annexation to Mountain Regional Water Special Service District is correctly shown hereon. No field survey was performed in the creation of this plat.

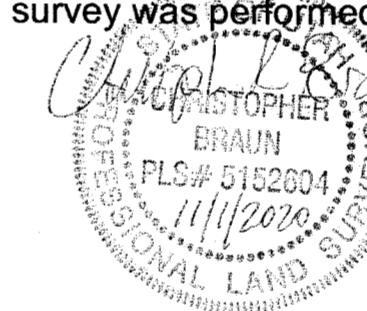

VICINITY MAP

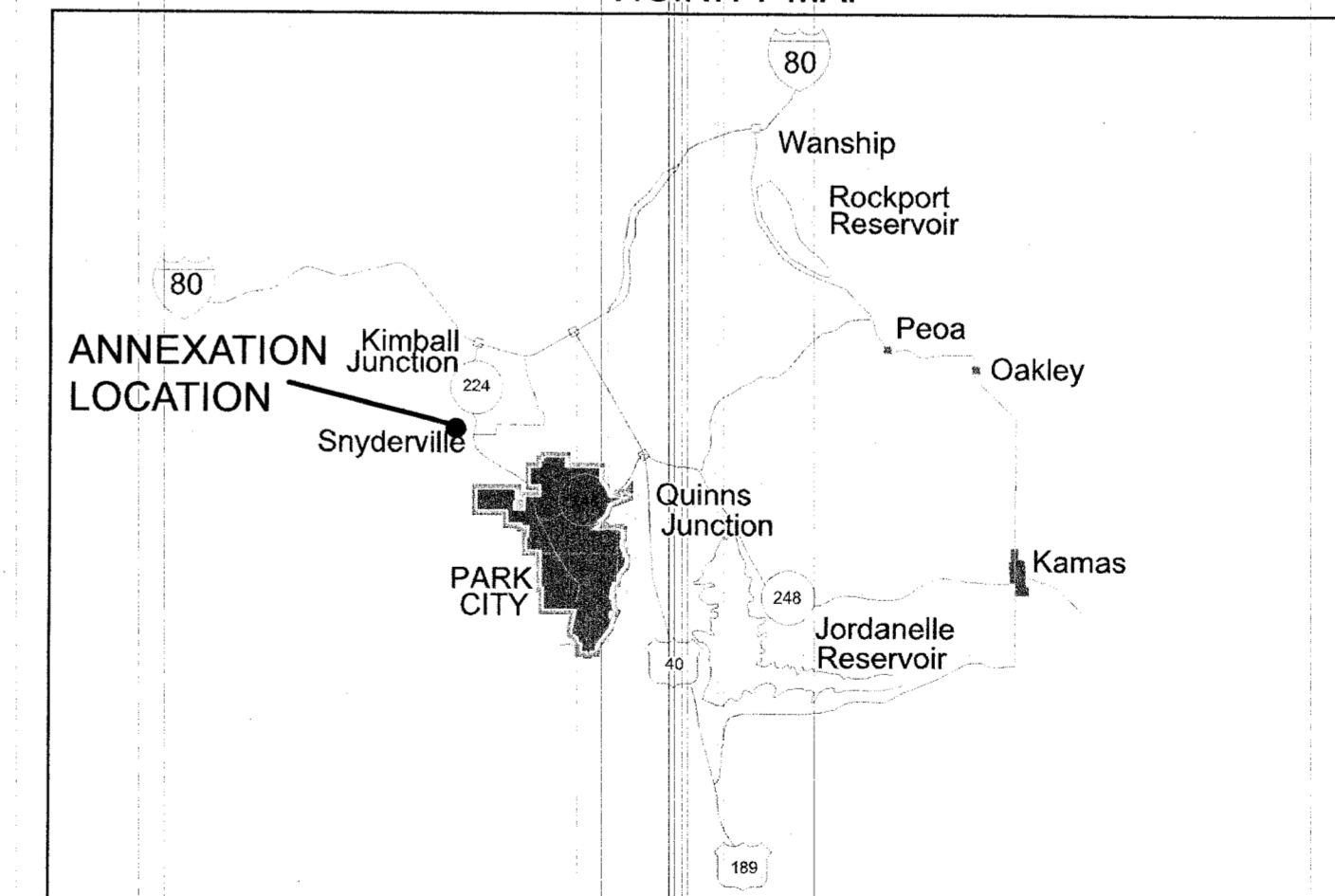

**Mountain Regional Water
Special Service District**



By C. Braun
Date: 5/7/2020

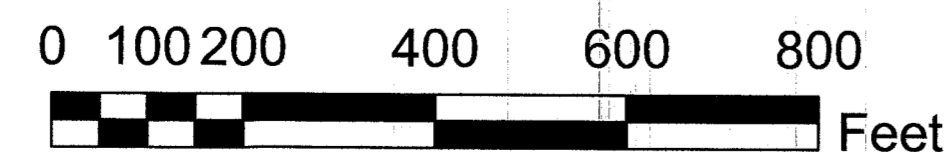

1 inch = 200 feet

APPROVED AS TO FORM
SUMMIT COUNTY ATTORNEY

BY Helen Stachay DATE 11-13-20

APPROVED AS TO FORM
SUMMIT COUNTY SURVEYOR

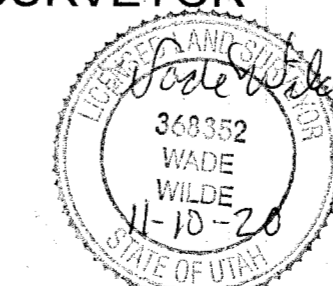

COUNTY SURVEYOR FILING

FILE NO. S0010287

11/30/2020 09:19:26 AM B: 0002 P: 1754

SURVEYED BY RECORDER

FEE \$ 6.00 BY MOUNTAIN REGIONAL WATER

SUMMIT COUNTY RECORDER