

STATE OF UTAH



OFFICE OF THE LIEUTENANT GOVERNOR

CERTIFICATE OF ANNEXATION

I, Deidre M. Henderson, Lieutenant Governor of the State of Utah, hereby certify that there has been filed in my office a notice of annexation for CASTLE DALE CITY, June 17, 2021, complying with Section 10-2-406, Utah Code Annotated, 1953, as amended.

Now, therefore, notice is hereby given to all whom it may concern that the attached is a true and correct copy of the notice of annexation, referred to above, on file with the Office of the Lieutenant Governor pertaining to the CASTLE DALE CITY ANNEXATION, located in Emery County, State of Utah.

IN TESTIMONY WHEREOF, I have hereunto set my hand, and affixed the Great Seal of the State of Utah this 17th day of June, 2021 at Salt Lake City, Utah.



Deidre M. Henderson

DEIDRE M. HENDERSON
Lieutenant Governor

CASTLE DALE CITY
ORDINANCE 04 08 21

AN ORDINANCE ANNEXING CERTAIN REAL PROPERTY INTO CASTLE DALE CITY, AND PROVIDING FOR AN EFFECTIVE DATE.

WHEREAS, the Castle Dale City Council received a petition to annex certain real property described herein on February 12, 2021; and

WHEREAS, the petition for annexation has been accepted by resolution of the Castle Dale City Council and certified by the Castle Dale City Recorder in accordance with law; and

WHEREAS, a notice of the proposed annexation has been published and sent to affected entities; and

WHEREAS, no protests have been received from property owners or affected entities; and

WHEREAS, the Castle Dale City Council finds that it is in the best interest of the City and its residents to annex the area proposed for annexation and that the City is capable of providing municipal services to the area.

NOW, THEREFORE, BE IT ORDAINED by the City Council of Castle Dale City Council as follows:

Section 1. PURPOSE

The purpose of this ordinance is to annex certain real property into Castle Dale City in response to a valid petition from owners of private land within the area proposed for annexation that is at least one-half the value of all the private land in the proposed annexation and that covers a majority of the land proposed for annexation

Section 2. CLASSIFICATION

This is a noncode ordinance

Section 3. GENERAL PROVISIONS

Pursuant to the receipt of a valid petition, certification by the Castle Dale City Recorder, acceptance by the Castle Dale City Council and the completion of all statutory requirements prescribed by Utah State law, the following described real property is hereby annexed into the City of Castle Dale.

BOUNDARY DESCRIPTION:

Beginning at a point which is located N 89°44'34" E, 566.00 feet along the Section Line and N 00°46'31" W, 33.00 feet from the Southwest Corner of the Southeast Quarter of the Southwest Quarter of Section 27, Township 18 South, Range 8 East, SLB&M, said point being on the existing Castle Dale City boundary; thence N 89°44'34" E, 92.89 feet along said existing boundary; thence S 00°15'28" E, 9.72 feet

along said existing boundary; thence N 89°44'34" E, 60.57 feet; thence S 00°46'31" E, 1.28 feet; thence N 89°44'34" E, 613.20 feet to the Quarter Section Line; thence N 89°08'32" E, 532.36 feet; thence N 00°37'23" W, 406.94 feet; thence S 89°08'32" W, 150.00 feet; thence S 00°59'49" E, 326.94 feet; thence S 89°08'32" W, 382.73 feet to the Quarter Section Line; thence S 89°44'34" W, 765.98 feet to the existing Castle Dale City Boundary; thence S 00°46'31" E, 69.00 feet along said existing boundary to the point of beginning.

Containing 3.58 acres, more or less.

Section 4. EFFECTIVE DATE

This ordinance shall take effect immediately upon passage and posting as required.

ENACTED by a duly constituted quorum of the Castle Dale City Council this 8th day of April, 2021.

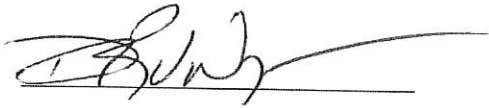

Danny Van Wagoner, Mayor

Castle Dale City

Crossroads of the San Rafael

Mayor

Danny Van Wagoner

Council Members

Bradley Giles

Joel S. Dorsch

Julie Johansen

Douglas Weaver

Jordan Leonard

June 1, 2021

Lt Governor Deidre Henderson
Utah State Capitol
Complex Suite 220
Salt Lake City, UT 84114

RE: Certification by the municipal legislative body that all the necessary legal requirements relating to the boundary change regarding land owned by Casey Toomer, Rod Magnuson, and Art Olsen have been completed.

I hereby certify that all necessary legal requirements relating to the annexation of land owned by Casey Toomer, Rod Magnuson, and Art Olsen have been completed.

I can be reached at castledalerecorder@gmail.com or (435)-381-2115

Castle Dale City



City Recorder, Lael White

Auxiliary aids and services are available upon request to individuals with disabilities by calling (435) 381-2115
Individuals with speech and/or hearing impairments may call the Relay Utah by dialing 711.
Spanish Relay Utah 888-346-3162. Equal Opportunity Employer

PO Box 728, Castle Dale, UT 84513 Phone (435) 381-2115 email castledalecity@gmail.com

SURVEYOR'S CERTIFICATE

I HEREBY CERTIFY THAT THIS IS A TRUE AND ACCURATE MAP OF THE TRACT OF LAND TO BE ANNEXED TO CASTLE DALE CITY, EMERY COUNTY, UTAH.

Wesley R. Allred
 WESLEY R. ALLRED
 DATE: 7/27/21



BOUNDARY DESCRIPTION

Beginning at a point which is located N 89°42'34" E, 696.00 feet along the Section Line to 00°00'00" W, 33.00 feet from the Southwest Corner of the Southeast Quarter of the Southwest Quarter of Township 18 South, Range 8 East, S13&M, said point being on the existing Castle Dale, UT 89°42'34" E, 696.00 feet along said existing boundary; thence S 00°15'23" E, 67.72 feet along the Section Line to 89°42'34" E, 86.57 feet; thence S 00°46'31" E, 1.28 feet; thence N 89°42'34" E, 812.55 feet; thence S 00°00'00" W, 33.00 feet; thence N 89°42'34" E, 326.34 feet; thence S 89°05'22" E, 532.53 feet; thence N 00°17'23" W, 406.84 feet; thence S 89°05'22" E, 303.05 feet to the City Boundary; thence S 89°05'22" E, 86.00 feet along said existing boundary to the point of beginning. Containing 3.28 acres, more or less.

ACCEPTANCE BY LEGISLATIVE BODY

THIS IS TO CERTIFY THAT WE, THE CASTLE DALE CITY COUNCIL HAVE REVIEWED THE SURVEY AND MAP AND IN A MAJORITY OF THE OWNERS OF THE TRACT SHOWN HEREON, REQUESTS THAT WE ANNEX THE TRACT TO THE CITY OF CASTLE DALE AND THAT A COPY OF THE ORDINANCE ANNEXED TO THE SURVEY AND MAP BEING HEREWITH, ALL IN ACCORDANCE WITH THE UTAH CODE, AS REVISED, BE FORWARDED TO THE STATE ENGINEER FOR APPROVAL AND ACCEPT THE ANNEXATION ORDERED, AND DO HEREBY APPROVE AND ACCEPT THE ANNEXATION ORDERED AND DO HEREBY ANNEX TO SAID CITY AND THAT SAID TRACT OF LAND IS KNOWN AS THE 2021 CASEY TOOMER ANNEXATION.

DATED THIS 27 DAY OF April 2021

[Signatures]
 MAYOR
 COUNCILMAN
 COUNCILMAN
 COUNCILMAN

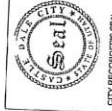

[Signature]
 RECORDER

2021 CASEY TOOMER
 ANNEXATION
 TO
 CASTLE DALE CITY
 EMERY COUNTY, UTAH

COUNTY RECORDER

COUNTY SURVEYOR APPROVAL
 I HAVE REVIEWED THE FINAL LOCAL ENTITY PLAN AND HAVE EXAMINED THE SURVEY AND MAP AND THE REQUIREMENTS OF THE UTAH CODE, AS REVISED, AND DO HEREBY APPROVE THIS 27 DAY OF April 2021



CONTRACT NO. 2021-0001

- LEGEND
- SECTION CORNER
 - SECTION LINE
 - QUARTER SECTION LINE
 - ANNEXATION BOUNDARY
 - CITY BOUNDARY
 - STREET OR ROAD
 - R.O.W.

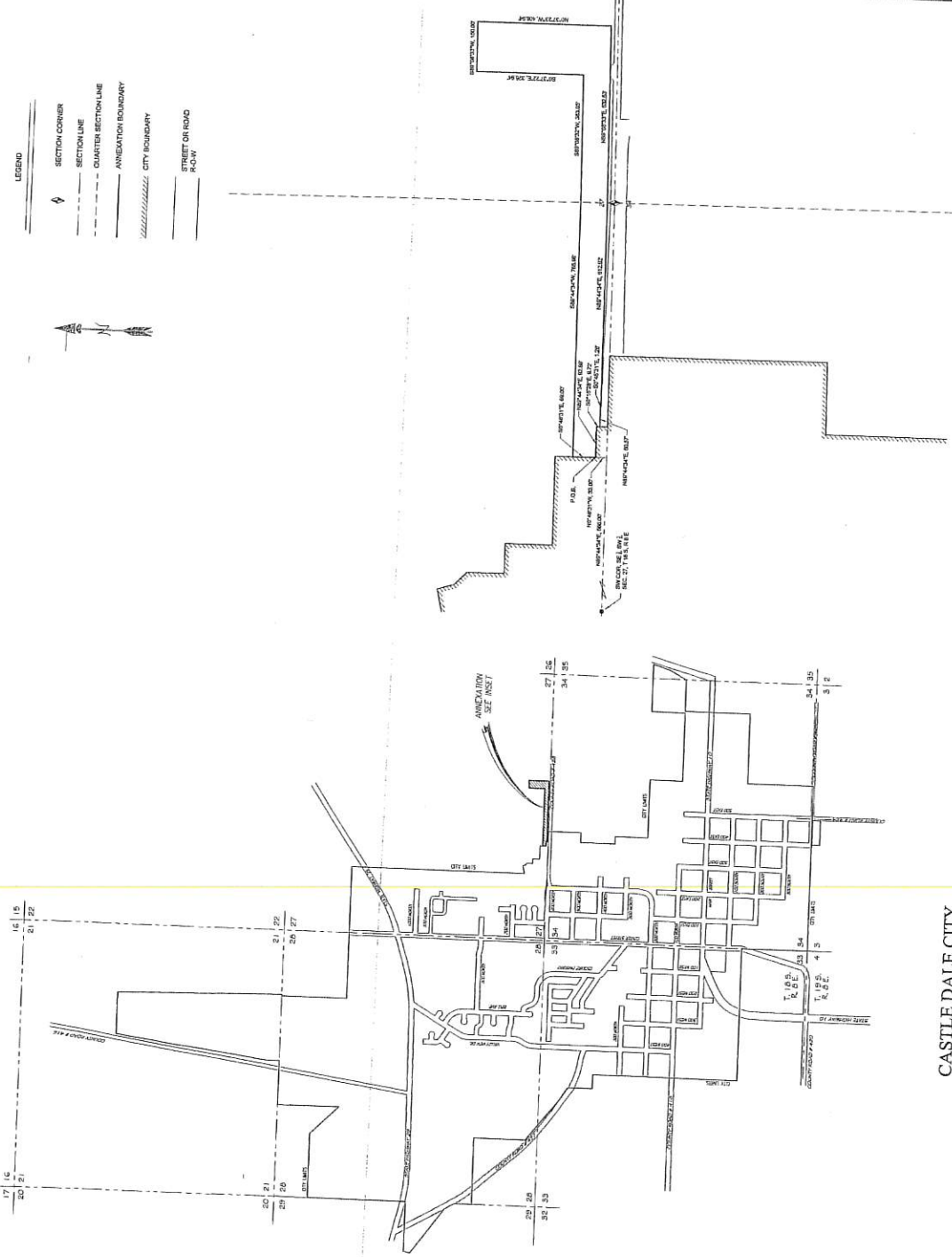

2021 CASEY TOOMER ANNEXATION

SCALE: 1" = 150'

PREPARED BY:
 PHOTONIC SURVEYING & MAPPING, LLC
 1101 West 100th Street, Suite 100
 Provo, UT 84601
 (435) 311-2522 Fax: (435) 311-2522
 www.photonicmapping.com

DRAWN: MKA, 2021 | CHECKED: BTJ, 2/17/21