

STATE OF UTAH



OFFICE OF THE LIEUTENANT GOVERNOR

CERTIFICATE OF ANNEXATION

I, Deidre M. Henderson, Lieutenant Governor of the State of Utah, hereby certify that there has been filed in my office a notice of annexation for the MOUNTAIN REGIONAL WATER SPECIAL SERVICE DISTRICT RESOLUTION NO. MRW 2022-11, located in SUMMIT COUNTY, dated AUGUST 4, 2022, complying with Section §17D-1-403, Utah Code Annotated, 1953, as amended.

Now, therefore, notice is hereby given to all whom it may concern that the attached is a true and correct copy of the notice of annexation, referred to above, on file with the Office of the Lieutenant Governor pertaining to the MOUNTAIN REGIONAL WATER SPECIAL SERVICE DISTRICT RESOLUTION NO. MRW 2022-11, located in SUMMIT COUNTY, State of Utah.

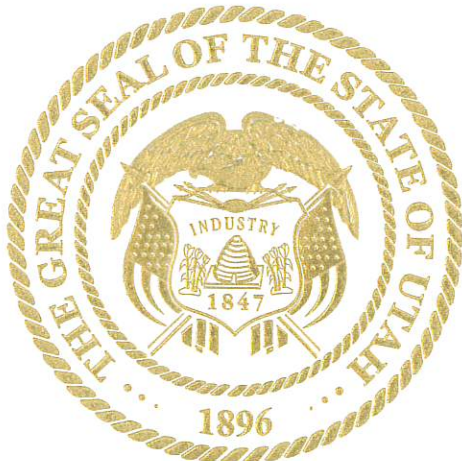

IN TESTIMONY WHEREOF, I have hereunto set my hand, and affixed the Great Seal of the State of Utah this 4th day of August, 2022 at Salt Lake City, Utah.

A handwritten signature in black ink, reading 'Deidre M. Henderson'.

DEIDRE M. HENDERSON
Lieutenant Governor

Notice of Impending Boundary Action

Pursuant to Utah Code Annotated §67-1a-6.5, the County Council of Summit County hereby provides the Lieutenant Governor's Office with written notice of an impending boundary action that effects Summit County and the Mountain Regional Water Special Service District.

The Summit County Council seeks a certificate of annexation as it relates to the Mountain Regional Water Special Service District. On July 6, 2022, the Summit County Council adopted Resolution MRW 2022-11 to annex certain property, Summit County Tax Parcel Number RCDA-14-15-E. Said parcel is solely owned by TCFC PropCo, LP as set forth in the resolution.

The Summit County Council hereby certifies that the attached constitutes a true and correct copy of the Resolution annexing territory into the boundaries of the Mountain Regional Water Special Service District as well as the final local entity plat. The Summit County Council further certifies that all the requirements for the annexation of territory into the boundaries of the Mountain Regional Water Special Service District have been complied with pursuant to Utah Code Annotated §17D-1-101 et. seq.

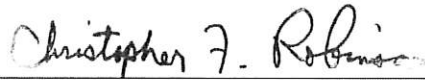

CHAIRPERSON OF THE SUMMIT COUNTY COUNCIL

IN WITNESS WHEREOF, I have hereunto set my hand and affixed the corporate seal of said County this 14th day of July, 2022.

_____ COUNTY CLERK



RESOLUTION NO. MRW 2022-11

**A RESOLUTION ANNEXING CERTAIN REAL PROPERTY TO THE MOUNTAIN
REGIONAL WATER SPECIAL SERVICE DISTRICT
(RCDA-14-15-E)**

WHEREAS, the Summit County Council of Summit County, Utah (the "Council"), established a local district designated as the Mountain Regional Water Special Service District (the "District"), to provide water services within its boundaries; and

WHEREAS, Utah Code Ann. §17D-1-401 provides that additional land from that specified in the resolution establishing a local district may be annexed to the District in conformance with the applicable procedures; and

WHEREAS, §17D-1-203 and §17D-1-401(2) provide that the Council, may be petitioned to annex an area into the District; and

WHEREAS, there have been numerous annexations into the District since its establishment in 1987; and

WHEREAS, TCFC PropCo, LP, has petitioned the Council to annex its land into the District (the "Petition"). In the Petition, TCFC PropCo, LP, represented that it is the sole owner of **RCDA-14-15-E**; and

WHEREAS, the Summit County Clerk has certified the Petition; and

WHEREAS, §17D-1-402 provides that the notice, hearing, and protest period do not apply if a petition for annexation of additional area is filed with the signatures of all of the owners of taxable real property;

WHEREAS, TCFC PropCo, LP has signed the Petition for annexation.

NOW, THEREFORE, BE IT RESOLVED by the Summit County Council as follows:

Section 1. FINDINGS. The Council finds and determines that public health, convenience, and necessity requires that certain land situated in Summit County, State of Utah, being generally described as parcel **RCDA-14-15-E** located in Summit County, Utah (the "Property") be annexed into the District.

Section 2. ANNEXATION. The Property is hereby annexed into the boundaries of Mountain Regional Water Special Service District. The property annexed shall be governed by and become an integral part of the District. Pursuant to this annexation, the owners of the Property shall be entitled, upon entering into a Water Service Agreement with the District, to receive the benefit of water services and facilities provided by the District, and shall be subject to the rights, powers and authority of the District, including, without limitation, the right, power and authority of the District to promulgate rules and regulations for the operation of the District, to levy ad valorem taxes on the Property, and to impose such fees and charges as shall be necessary to pay for all or part of the commodities, facilities and services to be provided by the District for the payment of the District's bonds and other obligations.

Section 3. Direction. All officers and employees of the District are hereby directed to take such action as shall be necessary and appropriate to effectuate the provisions of this Resolution and the intent expressed herein.

Section 4. Effective Date. This Resolution shall take effect immediately upon its approval and adoption by the Summit County Council.

APPROVED AND ADOPTED this 6th day of July, 2022

SUMMIT COUNTY COUNCIL
SUMMIT COUNTY, UTAH

Christopher F. Robinson

Chris Robinson
Chair

ATTEST:

Evelyn Furse

Evelyn Furse
County Clerk



APPROVED AS TO FORM:

David L. Thomas

David L. Thomas
Chief Civil Deputy

ANNEXATION TO MOUNTAIN REGIONAL WATER SPECIAL SERVICE DISTRICT

Parcel RCDA-14-15-E

A Parcel of Land Located in the Southeast Quarter of Section 36, Township 1 South, Range 3 East, Salt Lake Base and Meridian

BY RESOLUTION NO. MRW2022-11

Legal:

All of Parcel E of the Resort Core Development Area - RC14 & RC15 Subdivision Plat, on file and of record in the Office of the Summit County Recorder.

Tax ID: RCDA-14-15-E

SURVEYORS CERTIFICATE

I, Christopher Braun, do hereby certify that I am a licensed land surveyor and I hold license number 5152604 as prescribed under the laws of the State of Utah. I further certify that this plat has been made under my direction in compliance with Section 17A-2-125(4) and that the annexation to Mountain Regional Water Special Service District is correctly shown hereon. No field survey was conducted in the creation of this plat.



VICINITY MAP

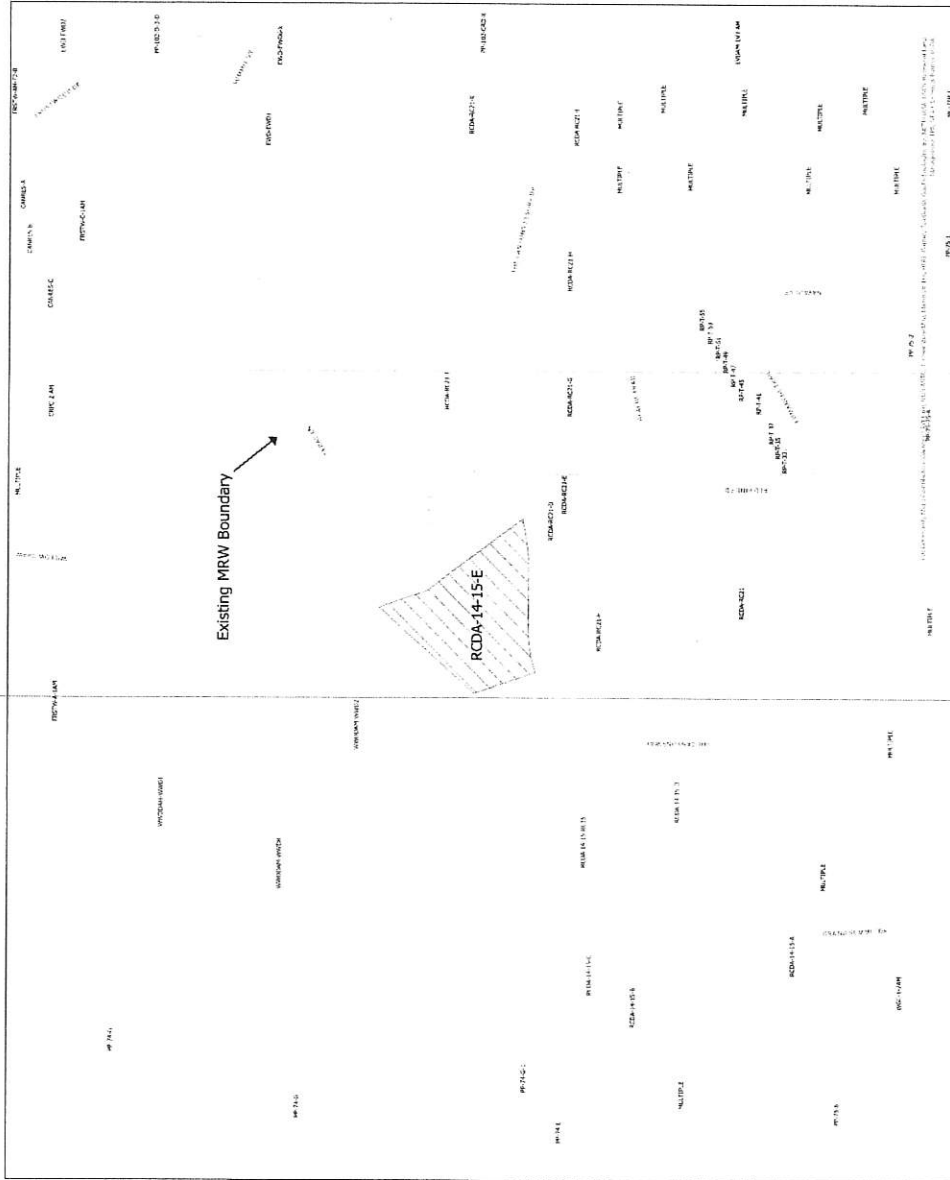
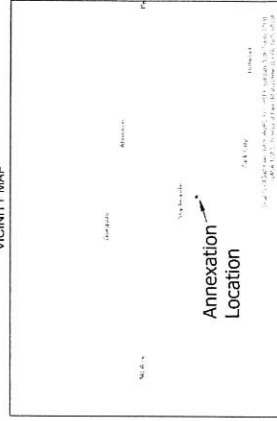

By K. Baird,
Date: 7/27/2022



1:100

APPROVED AS TO FORM
SUMMIT COUNTY ATTORNEY

BY *[Signature]*
DATE 7-27-2022

APPROVED AS TO FORM
SUMMIT COUNTY SURVEYOR

[Signature]
CHRISTOPHER BRAUN
LICENSED SURVEYOR
NO. 5152604
STATE OF UTAH

SUMMIT COUNTY RECORDER